

1/10 LUXURY ELECTRIC TOURING CAR



**MADE IN
EUROPE**

**INSTRUCTION
MANUAL**

**WORLD
CHAMPION**

XRAY®

BEFORE YOU START

The T4 is a high-competition, high-quality, 1/10-scale touring car intended for persons aged 16 years and older with previous experience building and operating RC model racing cars. This is not a toy; it is a precision racing model. This model racing car is not intended for use by beginners, inexperienced customers, or by children without direct supervision of a responsible, knowledgeable adult. If you do not fulfill these requirements, please return the kit in unused and unassembled form back to the shop where you have purchased it.

Before building and operating your T4, **YOU MUST** read through all of the operating instructions and instruction manual and fully understand them to get

CUSTOMER SUPPORT

We have made every effort to make these instructions as easy to understand as possible. However, if you have any difficulties, problems, or questions, please do not hesitate to contact the XRAY support team at info@teamxray.com. Also, please visit our Web site at www.teamxray.com to find the latest updates, set-up information, option parts, and many other goodies. We pride ourselves on taking excellent care of our customers.

You can join thousands of XRAY fans and enthusiasts in our online community at:

www.teamxray.com

Failure to follow these instructions will be considered as abuse and/or neglect.

SAFETY PRECAUTIONS

Contains:

LEAD (CAS 7439-92-1) ANTIMONY (CAS 7440-36-0)

WARNING: This product contains a chemical known to the state of California to cause cancer and birth defects or other reproductive harm.

CAUTION: CANCER HAZARD

Contains lead, a listed carcinogen. Lead is harmful if ingested. Wash thoroughly after using. **DO NOT** use product while eating, drinking or using tobacco products. May cause chronic effects to gastrointestinal tract, CNS, kidneys, and blood. **MAY CAUSE BIRTH DEFECTS.**

When building, using and/or operating this model always wear protective glasses and gloves.

Take appropriate safety precautions prior to operating this model. You are responsible for this model's assembly and safe operation! Please read the instruction manual before building and operating this model and follow all safety precautions. Always keep the instruction manual at hand for quick reference, even after completing the assembly. Use only genuine and original authentic XRAY parts for maximum performance. Using any third party parts on this model will void guaranty immediately.



IMPORTANT NOTES - GENERAL

- This product is not suitable for children under 16 years of age without the direct supervision of a responsible and knowledgeable adult.
- Carefully read all manufacturers warnings and cautions for any parts used in the construction and use of your model.
- Assemble this kit only in places away from the reach of very small children.
- First-time builders and users should seek advice from people who have building experience in order to assemble the model correctly and to allow the model to reach its performance potential.
- Exercise care when using tools and sharp instruments.
- Take care when building, as some parts may have sharp edges.
- Keep small parts out of reach of small children. Children must not be allowed to put any parts in their mouth, or pull vinyl bag over their head.
- Read and follow instructions supplied with paints and/or cement, if used (not included in kit).
- Immediately after using your model, do NOT touch equipment on the model such as the motor and speed controller, because they generate high temperatures. You may seriously burn yourself seriously touching them.
- Follow the operating instructions for the radio equipment at all times.
- Do not put fingers or any objects inside rotating and moving parts, as this may cause damage or serious injury as your finger, hair, clothes, etc. may get caught.
- Be sure that your operating frequency is clear before turning on or running your model, and never share the same frequency with somebody else at the same time. Ensure that others are aware of the operating frequency you are using and when you are using it.
- Use a transmitter designed for ground use with RC cars. Make sure that no one else is using the same frequency as yours in your operating area. Using the same frequency at the same time, whether it is driving, flying or sailing, can cause loss of control of the RC model, resulting in a serious accident.
- Always turn on your transmitter before you turn on the receiver in the car. Always turn off the receiver before turning your transmitter off.
- Keep the wheels of the model off the ground when checking the operation of the radio equipment.
- Disconnect the battery pack before storing your model.
- When learning to operate your model, go to an area that has no obstacles that can damage your model if your model suffers a collision.
- Remove any sand, mud, dirt, grass or water before putting your model away.
- If the model behaves strangely, immediately stop the model, check and clear the problem.
- To prevent any serious personal injury and/or damage to property, be responsible when operating all remote controlled models.
- The model car is not intended for use on public places and roads or areas where its operation can conflict with or disrupt pedestrian or vehicular traffic.
- Because the model car is controlled by radio, it is subject to radio interference from many sources that are beyond your control. Since radio interference can cause momentary loss of control, always allow a safety margin in all directions around the model in order to prevent collisions.
- Do not use your model:
 - Near real cars, animals, or people that are unaware that an RC car is being driven.
 - In places where children and people gather
 - In residential districts and parks
 - In limited indoor spaces
 - In wet conditions
 - In the street
 - In areas where loud noises can disturb others, such as hospitals and residential areas.
 - At night or anytime your line of sight to the model may be obstructed or impaired in any way.

the maximum enjoyment and prevent unnecessary damage. Read carefully and fully understand the instructions before beginning assembly.

Make sure you review this entire manual, download and use set-up book from the web, and examine all details carefully. If for some reason you decide The T4 is not what you wanted or expected, **do not continue any further**. Your hobby dealer cannot accept your T4 kit for return or exchange after it has been partially or fully assembled.

Contents of the box may differ from pictures. In line with our policy of continuous product development, the exact specifications of the kit may vary without prior notice.

XRAY Europe

K Vystavisku 6992
91101 Trenčín
Slovakia, EUROPE
Phone: 421-32-7401100
Fax: 421-32-7401109
E-mail: info@teamxray.com

XRAY USA

RC America, 2030 Century Center Blvd #15
Irving, TX 75062
USA
Phone: (800) 519-7221 * (214) 744-2400
Fax: (214) 744-2401
E-mail: xray@rcamerica.com

Improper operation may cause personal and/or property damage. XRAY and its distributors have no control over damage resulting from shipping, improper construction, or improper usage. XRAY assumes and accepts no responsibility for personal and/or property damages resulting from the use of improper building materials, equipment and operations. By purchasing any item produced by XRAY, the buyer expressly warrants that he/she is in compliance with all applicable federal, state and local laws and regulation regarding the purchase, ownership and use of the item. The buyer expressly agrees to indemnify and hold harmless XRAY for all claims resulting directly or indirectly from the purchase, ownership or use of the product. By the act of assembling or operating this product, the user accepts all resulting liability. If the buyer is not prepared to accept this liability, then he/she should return this kit in new, unassembled, and unused condition to the place of purchase.

IMPORTANT NOTES – ELECTRICAL

- Insulate any exposed electrical wiring (using heat shrink tubing or electrical tape) to prevent dangerous short circuits. Take maximum care in wiring, connecting and insulating cables. Make sure cables are always connected securely. Check connectors for if they become loose. And if so, reconnect them securely. Never use R/C models with damaged wires. A damaged wire is extremely dangerous, and can cause short-circuits resulting in fire. Please have wires repaired at your local hobby shop.
- Low battery power will result in loss of control. Loss of control can occur due to a weak battery in either the transmitter or the receiver. Weak running battery may also result in an out of control car if your car's receiver power is supplied by the running battery. Stop operation immediately if the car starts to slow down.
- When not using RC model, always disconnect and remove battery.
- Do not disassemble battery or cut battery cables. If the running battery short-circuits, approximately 300W of electricity can be discharged, leading to fire or burns. Never disassemble battery or cut battery cables.
- Use a recommended charger for the receiver and transmitter batteries and follow the instructions correctly. Over-charging, incorrect charging, or using inferior chargers can cause the batteries to become dangerously hot.

Recharge battery when necessary. Continual recharging may damage battery and, in the worst case, could build up heat leading to fire. If battery becomes extremely hot during recharging, please ask your local hobby shop for check and/or repair and/or replacement.

- Regularly check the charger for potential hazards such as damage to the cable, plug, casing or other defects. Ensure that any damage is rectified before using the charger again. Modifying the charger may cause short-circuit or overcharging leading to a serious accident. Therefore do not modify the charger.
- Always unplug charger when recharging is finished.
- Do not recharge battery while battery is still warm. After use, battery retains heat. Wait until it cools down before charging.
- Do not allow any metal part to short circuit the receiver batteries or other electrical/electronic device on the model.
- Immediately stop running if your RC model gets wet as may cause short circuit.
- Please dispose of batteries responsibly. Never put batteries into fire.

R/C & BUILDING TIPS

- Make sure all fasteners are properly tightened. Check them periodically.
- Make sure that chassis screws do not protrude from the chassis.
- For the best performance, it is very important that great care is taken to ensure the free movement of all parts.
- Clean all ball-bearings so they move very easily and freely.
- Tap or pre-thread the plastic parts when threading screws.
- Self-tapping screws cut threads into the parts when being tightened. Do not use excessive force when tightening the self-tapping screws because you may strip out the thread in the plastic. We recommended you stop tightening a screw when you feel some resistance.
- Ask your local hobby shop for any advice.

Please support your local hobby shop. We at XRAY Model Racing Cars support all local hobby dealers. Therefore we ask you, if at all possible, to purchase XRAY products at your hobby dealer and give them your support like we do. If you have difficulty finding XRAY products, please check out www.teamxray.com to get advice, or contact us via email at info@teamxray.com, or contact the XRAY distributor in your country.

WARRANTY

XRAY guarantees this model kit to be free from defects in both material and workmanship within 30 days of purchase. The total monetary value under warranty will in no case exceed the cost of the original kit purchased. This warranty does not cover any components damaged by use or modification or as a result of wear. Part or parts missing from this kit must be reported within 30 days of purchase. No part or parts will be sent under warranty without proof of purchase. Should you find a defective or missing part, contact the local distributor. Service and customer support will be provided through local hobby store where you have purchased the kit, therefore make sure to purchase any XRAY products at your local hobby store. This model racing car is considered to be a high-performance racing vehicle. As such this vehicle will be used in an extreme range of conditions and situations, all which may cause premature wear or failure of any component. XRAY has no control over usage of vehicles once they leave the dealer, therefore XRAY can only offer warranty against all manufacturer's defects in materials, workmanship, and assembly at point of sale and before use. No warranties are expressed or implied that cover damage caused by what is considered normal use, or cover or imply how long any model cars' components or electronic components will last before requiring replacement.

Due to the high performance level of this model car you will need to periodically maintain and replace consumable components. Any and all warranty coverage will not cover replacement of any part or component damaged by neglect, abuse, or improper or unreasonable use. This includes but is not limited to

damage from crashing, chemical and/or water damage, excessive moisture, improper or no maintenance, or user modifications which compromise the integrity of components. Warranty will not cover components that are considered consumable on RC vehicles. XRAY does not pay nor refund shipping on any component sent to XRAY or its distributors for warranty. XRAY reserves the right to make the final determination of the warranty status of any component or part.

Limitations of Liability

XRAY makes no other warranties expressed or implied. XRAY shall not be liable for any loss, injury or damages, whether direct, indirect, special, incidental, or consequential, arising from the use, misuse, or abuse of this product and/or any product or accessory required to operate this product. In no case shall XRAY's liability exceed the monetary value of this product.

Take adequate safety precautions prior to operating this model. You are responsible for this model's assembly and safe operation.

Disregard of the any of the above cautions may lead to accidents, personal injury, or property damage. XRAY MODEL RACING CARS assumes no responsibility for any injury, damage, or misuse of this product during assembly or operation, nor any additions that may arise from the use of this product.

All rights reserved.

QUALITY CERTIFICATE

XRAY MODEL RACING CARS uses only the highest quality materials, the best compounds for molded parts and the most sophisticated manufacturing processes of TQM (Total Quality Management). We guarantee that all parts of a newly-purchased kit are manufactured with the highest regard to quality. However, due to the many factors inherent in model racecar competition, we cannot guarantee

any parts once you start racing the car. Products which have been worn out, abused, neglected or improperly operated will not be covered under warranty. We wish you enjoyment of this high-quality and high-performance RC car and wish you best success on the track!

In line with our policy of continuous product development, the exact specifications of the kit may vary. In the unlikely event of any problems with your new kit, you should contact the model shop where you purchased it, quoting the part number.

We do reserve all rights to change any specification without prior notice. All rights reserved.

SYMBOLS USED

Part bags used 	Assemble in the specified order 	Assemble left and right sides the same way 	Pay attention here 	Assemble as many times as specified (here twice) 	Apply thread lock 	Apply CA glue 	
Apply oil 	Apply grease 	Use pliers 	Ensure smooth non-binding movement 	Tighten screw gently 	CORRECT Overtightened	WRONG The threads are stripped.	Follow Set-Up Book

TOOLS REQUIRED

HUDY TOOLS: Allen: 1.5mm, 2.0mm, 3.0mm Socket: 5.5mm, 7.0mm 	Combination Pliers (HUDY #189020) 	Side Cutters (HUDY #189010) 	Hobby Knife 	Turnbuckle Wrench 4mm (HUDY #181040) 	Reamer (HUDY #107600) or (HUDY #107601)
			Scissors (HUDY #188990) 		

EQUIPMENT INCLUDED

XRAY Premium Silicone Oil 400cSt (#359240) Oil 2000cSt (#359302) 	Graphite Grease (HUDY #106210)
--	---------------------------------------

NOT INCLUDED

	To ensure that you always have access to the most up-to-date version of the XRAY Set-up Book, XRAY will now be offering only the digital online version at our Web site at www.teamxray.com . By offering this online version instead of including a hardcopy printed version in kits, you will always be assured of having the most current updated version.	SAMPLE OF OPTIONAL PARTS <table border="1"> <tr> <td>#30XXXX</td> <td>OPTION 1</td> </tr> <tr> <td>#30XXXX</td> <td>OPTION 2</td> </tr> <tr> <td>#30XXXX</td> <td>OPTION 3</td> </tr> </table>	#30XXXX	OPTION 1	#30XXXX	OPTION 2	#30XXXX	OPTION 3	XRAY offers wide range of optional tuning parts which are listed in a table like this. Please refer to the exploded view of each main section to verify which part is included in the kit while all other parts are available only as an optional part and must be purchased separately.
#30XXXX	OPTION 1								
#30XXXX	OPTION 2								
#30XXXX	OPTION 3								

EQUIPMENT REQUIRED

Transmitter 	Receiver 	Steering Servo 	Electric Motor & Pinion Gear and Setscrew 	Bearing Oil (HUDY #106230) 	Speed Controller
190mm Bodysell 	LiPo Battery 	Lexan™ Paint 	Battery Charger 	Fibre Tape (HUDY #107870) Double-sided Tape 	Wheels & Tires & Inserts

COLOR INDICATIONS

At the beginning of each section is an exploded view of the parts to be assembled. There is also a list of all the parts and part numbers that are related to the assembly of that section.

The part descriptions are color-coded to make it easier for you to identify the source of a part. Here are what the different colors mean:

Style A - indicates parts that are included in the bag marked for the section.

STYLE B - indicates parts that are included in the box.

STYLE C - indicates parts that are already assembled from previous steps.

CHASSIS PREPARATION

To protect and seal edges of graphite parts, sand edges smooth and then apply CA glue.

Do this for: chassis edges, countersunk holes, and shock towers.

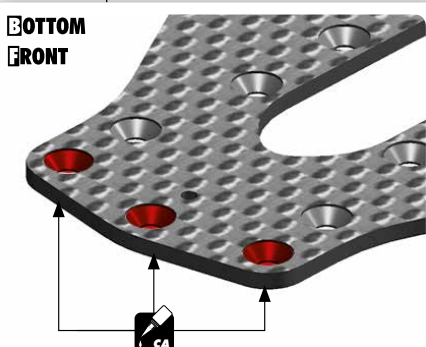
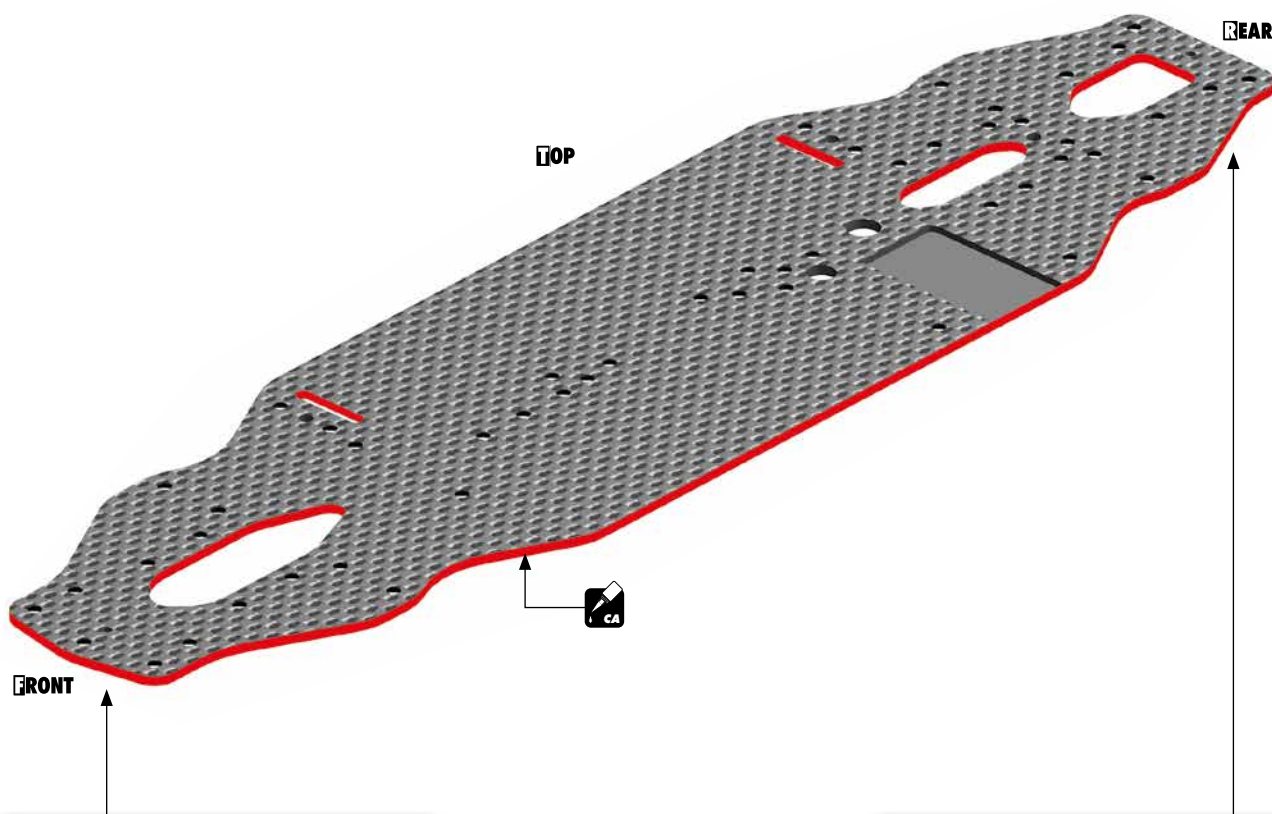

Apply only a bit of CA glue in the countersunk holes.

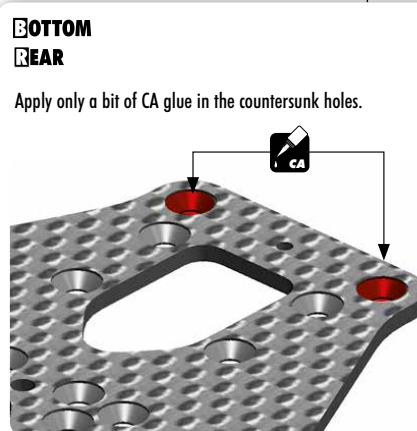

Apply only a bit of CA glue in the countersunk holes.

1. GEAR DIFFERENTIAL & FRONT SOLID AXLE

01.2

GEAR DIFFERENTIAL

OPTIONAL:

#304971 HUDY SPRING STEEL™ OUTDRIVES

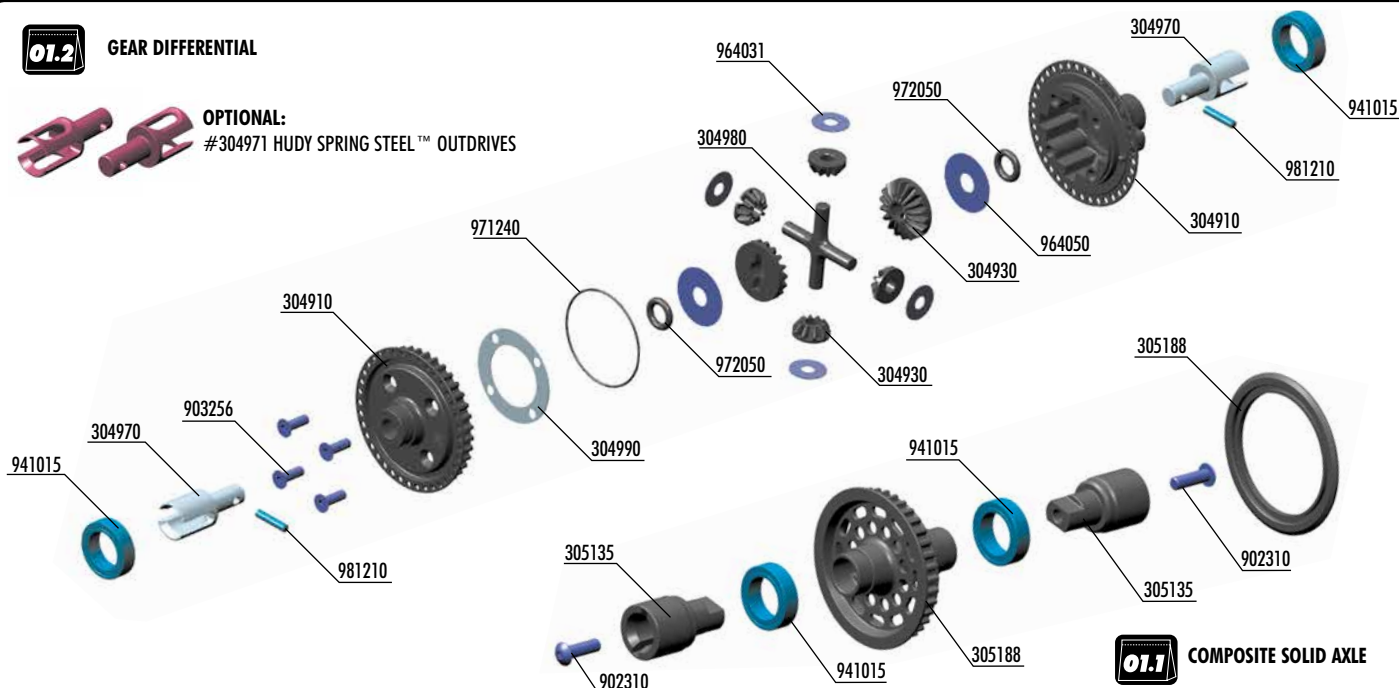

OPTIONAL:

#305136 ALU SOLID DRIVESHAFT ADAPTERS

OPTIONAL:

#305137 STEEL SOLID AXLE DRIVESHAFT ADAPTERS

BAG

01.1

01.2

- | | |
|---------|---|
| 30 4900 | XRAY GEAR DIFFERENTIAL - SET |
| 30 4910 | COMPOSITE GEAR DIFF. CASE & COVER |
| 30 4930 | COMPOSITE GEAR DIFF BEVEL & SATELLITE GEARS (2+4) |
| 30 4970 | ALU GEAR DIFF OUTDRIVE ADAPTER - 7075 T6 (2) |
| 30 4980 | COMPOSITE GEAR DIFF CROSS PIN |
| 30 4990 | DIFF GASKET (4) |
| 30 5105 | XRAY MULTI-DIFF T3/T4 LiPo (OPTION) |
| 30 5135 | COMPOSITE SOLID AXLE DRIVESHAFT ADAPTERS (2) |
| 30 5188 | COMPOSITE SOLID AXLE 38T - SET |

- | | |
|---------|---|
| 90 2310 | HEX SCREW SH M3x10 (10) |
| 90 3256 | HEX SCREW SFH M2.5x6 (10) |
| 94 1015 | HIGH-SPEED BALL-BEARING 10x15x4 RUBBER SEALED (2) |
| 96 4031 | WASHER S 3.5x10x0.2 (10) |
| 96 4050 | WASHER S 5x15x0.3 (10) |
| 97 1240 | SILICONE O-RING 24x0.7 (10) |
| 97 2050 | SILICONE O-RING 5x2 (10) |
| 98 1210 | PIN 2x10 (10) |



STEP 4 5 DETAIL

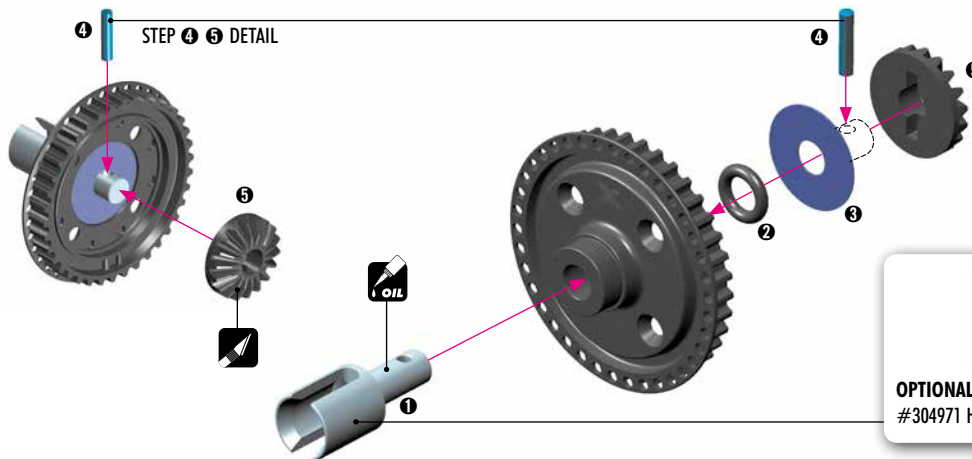

OPTIONAL:

#304971 HUDY SPRING STEEL™ OUTDRIVES



NOTE
ORIENTATION

ORIENTATION

STEP 4 DETAIL

Use tweezers to insert pin.

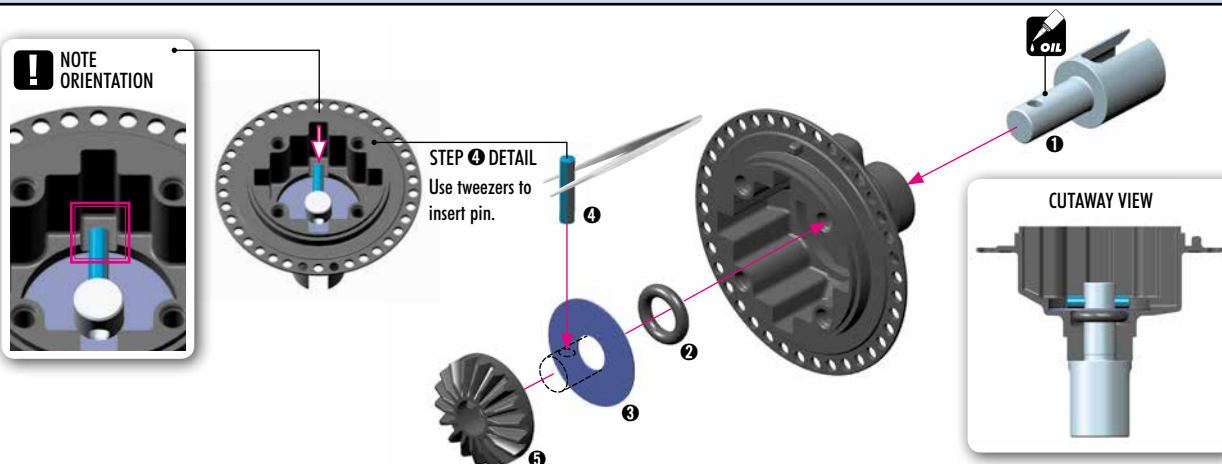

CUTAWAY VIEW

1. GEAR DIFFERENTIAL & FRONT SOLID AXLE

964031
S 3.5x10x0.2

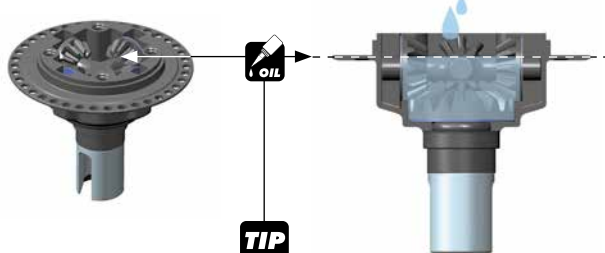
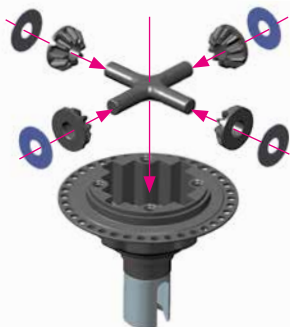

TIP
Fill differential up to the top of the diff pin. DO NOT fill the diff to the top of the housing.

TO ENSURE YOU HAVE THE SAME AMOUNT OF OIL FROM REBUILD TO REBUILD, DO THE FOLLOWING:



7.90g

#107865
HUDY Ultimate Digital Pocket
Scale 300g ± 0.01g



$$7.9g + 1.3g = 9.2g$$



9.20g

❶ Put the diff (without oil) on the scale and check the weight (approximately 7.90g)

❷ Slowly pour oil into the diff and watch the weight. Add 1.3g of oil into the diff. The approximate weight of the diff including oil is 9.20g.

TIP

TIPS FOR DIFFERENTIALS

TIP

LOW-TRACTION

1000cSt (HUDY #106410)
2000cSt (HUDY #106420)

MEDIUM-TRACTION

2000cSt (HUDY #106420)
3000cSt (HUDY #106430)
5000cSt (HUDY #106450)

HIGH-TRACTION

5000cSt (HUDY #106450)
6000cSt (HUDY #106460)
7000cSt (HUDY #106470)
8000cSt (HUDY #106480)
9000cSt (HUDY #106490)
10000cSt (HUDY #106510)

SUPER HIGH-TRACTION

10000cSt (HUDY #106510)
15000cSt (HUDY #106515)
20000cSt (HUDY #106520)

LOW-TRACTION

NOTE: Softer oil increases rear traction, harder oil increases on-power steering and stability. It is important not to use soft oils in high-traction conditions as this would not increase traction, but would make the car loose as the car would become too twitchy.

However, if the oil is too soft, it could generate the same effect like the car has no traction. Therefore it is very important to choose the correct oil very carefully. We suggest to always try soft oil and then harder oil to understand better the car behavior at the track and then choose the oil accordingly.

TIPS FOR FRONT DIFFERENTIAL

To increase on-power steering and cornering speed, the gear diff can also be used in the front. Note: If you use the gear diff in the front, we recommend using optional #304971 HUDY Spring Steel™ outdrives because the stress on the outdrives in the front is much higher than in the rear.

USE THESE OILS FOR FRONT DIFFERENTIAL

500,000 cSt (HUDY #106650)
1,000,000 cSt (HUDY #106692)

To make the front differential tighter, you can use cleaning gum instead of oil.

IMPORTANT! Using cleaning gum instead of oil in the gear differential can lead to gear breakage because the gears are working under dry conditions.

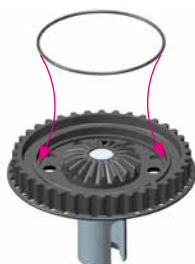
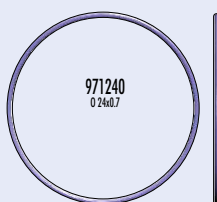

After disassembling the gear diff the large O-ring may have an increased size and may be more difficult to re-install. We recommend either inserting the old O-ring carefully in the diff cover, or replacing the old O-ring with a new O-ring if the old one cannot be made to fit properly.

1. GEAR DIFFERENTIAL & FRONT SOLID AXLE



BOTTOM DETAIL

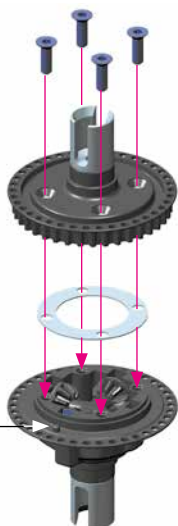
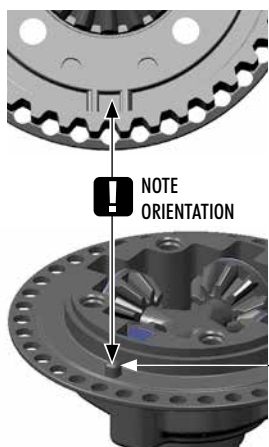

Tighten the screws equally but do NOT tighten them completely.

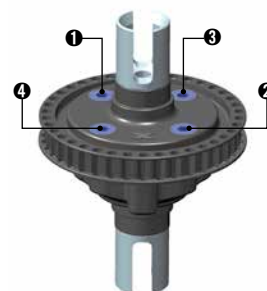

Finish tightening in this order.

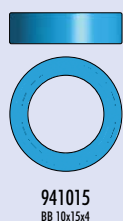

BEARING OIL
(HUDY #106230)

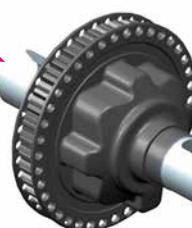

COMPOSITE FRONT SOLID AXLE

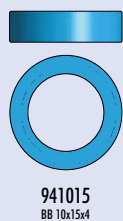
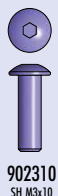

BEARING OIL
(HUDY #106230)

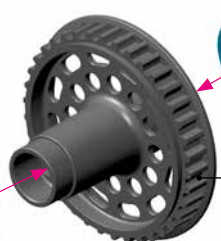
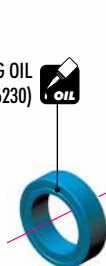

BEARING OIL
(HUDY #106230)

OPTIONAL:

#305137
STEEL SOLID AXLE DRIVESHAFT ADAPTERS

#305136
ALU SOLID DRIVESHAFT ADAPTERS

FRONT & REAR AXLES

#304900	GEAR DIFFERENTIAL
#305105	XRAY ALU MULTI-DIFF™
#305188	COMPOSITE SOLID AXLE 38T PULLEY

CUTAWAY VIEW

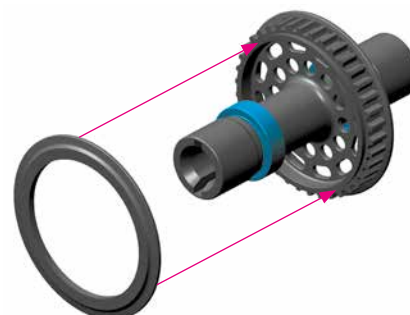
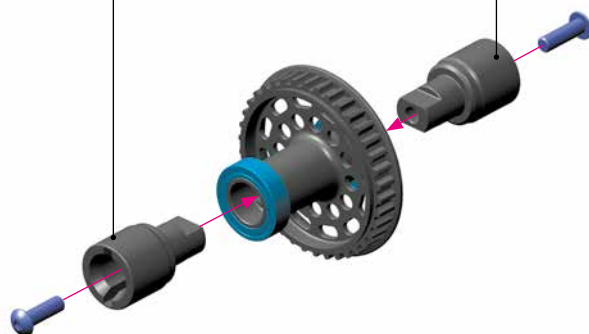
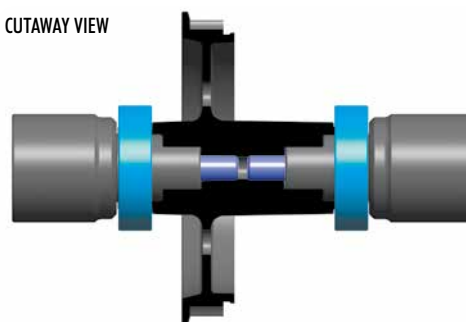

FRONT & REAR AXLES

2. CENTRAL TRANSMISSION

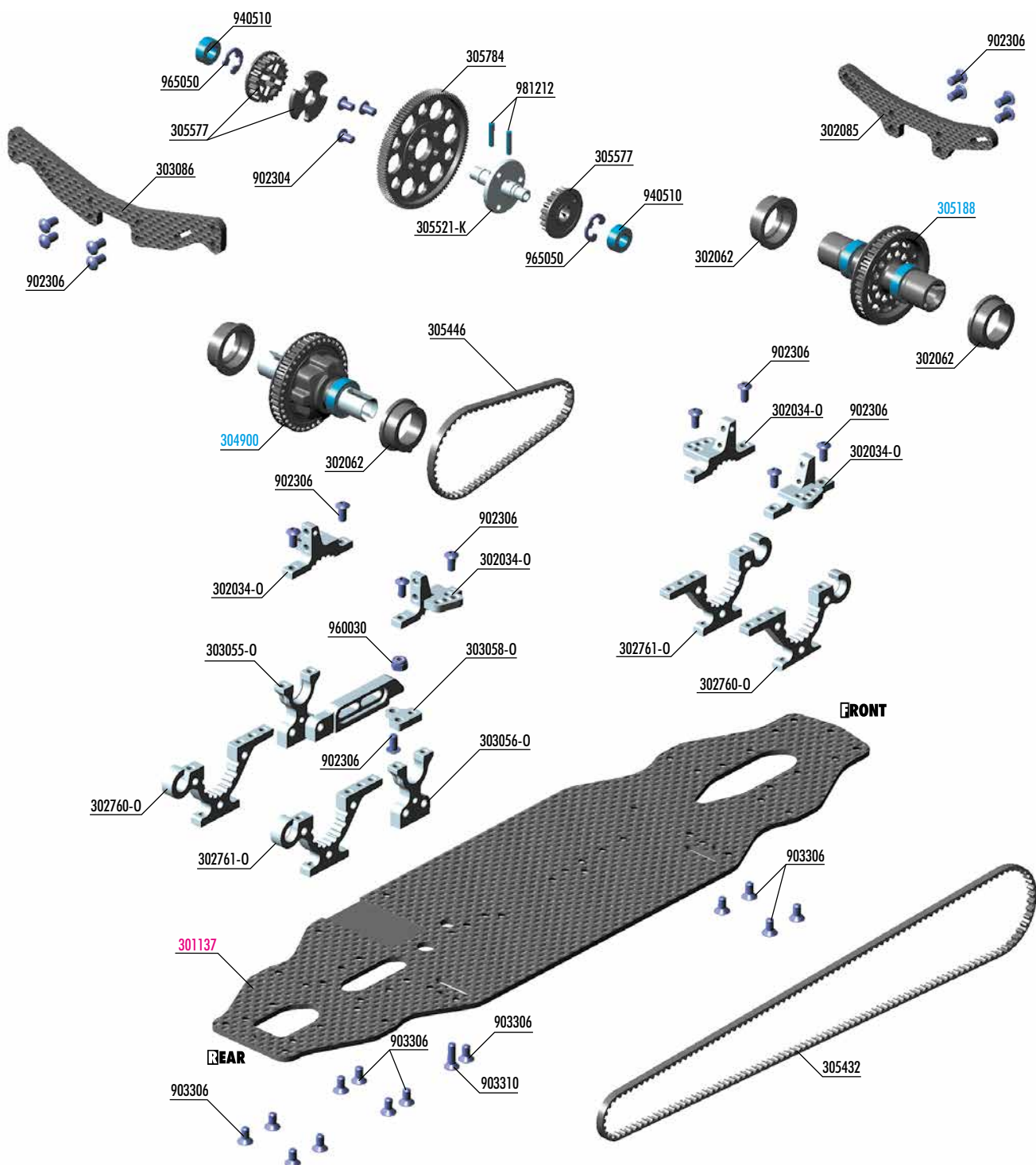

BAG

02

- 30 2034-0 T4 ALU UPPER CLAMP WITH 5 ADJ. ROLL-CENTERS (L + R) - ORANGE
- 30 2062 T4 COMPOSITE ADJUSTMENT BALL-BEARING HUB (4)
- 30 2085 T4 SHOCK TOWER FRONT 3.0MM GRAPHITE
- 30 2760-0 T4'15 ALU LOWER ADJUSTMENT BULKHEAD - FRONT R / REAR L - ORANGE
- 30 2761-0 T4'15 ALU LOWER ADJUSTMENT BULKHEAD - FRONT L / REAR R - ORANGE
- 30 3055-0 T4'15 ALU MOTOR MOUNT - ORANGE
- 30 3056-0 T4 ALU LAYSHAFT BULKHEAD CLOSED L/R - ORANGE
- 30 3058-0 T4'15 ALU MOTOR MOUNT PLATE - ORANGE
- 30 3086 T4 SHOCK TOWER REAR 3.0MM GRAPHITE
- 30 5432 HIGH-PERFORMANCE KEVLAR DRIVE BELT FRONT 3 x 513 MM
- 30 5446 HIGH-PERFORMANCE KEVLAR DRIVE BELT REAR 3 x 189 MM
- 30 5521-K ALU SOLID LAYSHAFT - BLACK
- 30 5577 COMPOSITE FIXED PULLEY 20T (2)
- 30 5778 OFFSET SPUR GEAR 78T / 48 (OPTION)
- 30 5781 OFFSET SPUR GEAR 81T / 48 (OPTION)
- 30 5784 SPUR GEAR 84T / 48
- 30 5862 OFFSET SPUR GEAR 92T / 64 (OPTION)
- 30 5866 OFFSET SPUR GEAR 96T / 64 (OPTION)
- 30 5870 OFFSET SPUR GEAR 100T / 64 (OPTION)

- 30 5874 OFFSET SPUR GEAR 104T / 64 (OPTION)
- 30 5876 OFFSET SPUR GEAR 106T / 64 (OPTION)
- 30 5878 OFFSET SPUR GEAR 108T / 64 (OPTION)
- 30 5880 OFFSET SPUR GEAR 110T / 64 (OPTION)
- 30 5882 OFFSET SPUR GEAR 112T / 64 (OPTION)
- 30 5884 OFFSET SPUR GEAR 114T / 64 (OPTION)
- 90 2304 HEX SCREW SH M3x4 - STAINLESS (10)
- 90 2306 HEX SCREW SH M3x6 (10)
- 90 3306 HEX SCREW SFH M3x6 (10)
- 90 3310 HEX SCREW SFH M3x10 (10)
- 94 0510 HIGH-SPEED BALL-BEARING 5x10x4 RUBBER SEALED (2)
- 96 0030 NUT M3 (10)
- 96 5050 E-CLIP 5 (10)
- 98 1212 PIN 2x12 (10)

- 30 4900 XRAY GEAR DIFFERENTIAL - SET
- 30 5188 COMPOSITE SOLID AXLE 38T - SET
- 30 1137 T4'15 CHASSIS 2.2MM GRAPHITE

2. CENTRAL TRANSMISSION

902306
SH M3x6

903306
SFH M3x6

903310
SFH M3x10

960030
N M3

NOTE ORIENTATION

FRONT

REAR

Do not tighten fully

It is not necessary to use this screw. The screw is used as reinforcement screw only.

Do not tighten fully

SH M3x6

NOTE ORIENTATION

IMPORTANT!

Tighten screws in order indicated.

M3 nut must always be tightened fully. When tightening the nut, use pliers.

902304
SH M3x4

965050
CS

981212
P 2x12

1.

2.

3.

NOTE ORIENTATION

Note orientation only when using XRAY OFFSET spur gears.

CUTAWAY VIEW

SPUR GEARS 48P	
#305778	OFFSET SPUR GEAR 78T / 48P
#305781	OFFSET SPUR GEAR 81T / 48P
#305784	SPUR GEAR 84T / 48P

SPUR GEARS 64P	
#305862	OFFSET SPUR GEAR 92T / 64P
#305866	OFFSET SPUR GEAR 96T / 64P
#305870	OFFSET SPUR GEAR 100T / 64P
#305874	OFFSET SPUR GEAR 104T / 64P
#305876	OFFSET SPUR GEAR 106T / 64P
#305878	OFFSET SPUR GEAR 108T / 64P
#305880	OFFSET SPUR GEAR 110T / 64P
#305882	OFFSET SPUR GEAR 112T / 64P
#305884	OFFSET SPUR GEAR 114T / 64P

940510
BB 5x10x4

NOTE ORIENTATION

BEARING OIL (HUDY #106230)

Short belt Long belt

BEARING OIL (HUDY #106230)

FRONT

REAR

NOTE ORIENTATION

REAR

2. CENTRAL TRANSMISSION



FRONT BELT TENSION ADJUSTMENT

Front diff upper position provides more steering but provides less front traction. Recommended for medium - high grip tracks and technical tracks.

Front diff lower position provides more front traction but makes the car push more on power. Recommended for low traction tracks.

FRONT

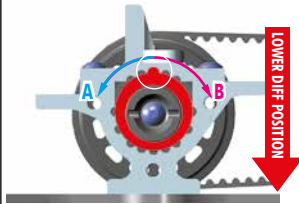
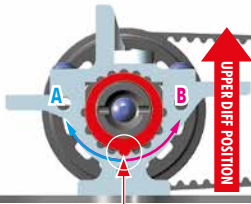

INITIAL POSITION
PLACE TAB IN THIS BOTTOM NOTCH

TO LOOSEN FRONT BELT: Rotate both front nylon hubs in arrow direction **A**

TO TIGHTEN FRONT BELT: Rotate both front nylon hubs in arrow direction **B**



REAR BELT TENSION ADJUSTMENT

Rear diff upper position provides more on-power steering but makes the rear slightly more loose. Recommended for medium - high traction tracks.

Rear diff lower position provides more rear traction, mainly on power traction and makes the car more stable in the chicanes, but makes the car push more on power. Recommended for low - medium traction tracks.

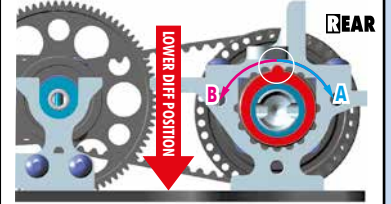
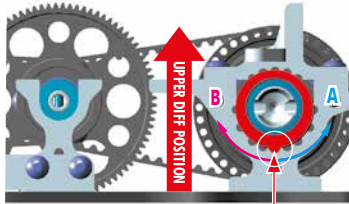

INITIAL POSITION
PLACE TAB IN THIS BOTTOM NOTCH

TO LOOSEN REAR BELT: Rotate both rear nylon hubs in arrow direction **A**

TO TIGHTEN REAR BELT: Rotate both rear nylon hubs in arrow direction **B**



OPTIONAL:

#303071 Belt Tensioner may be used when the front belt becomes worn and loose. Belt tensioner is NOT included in the kit and must be purchased separately.

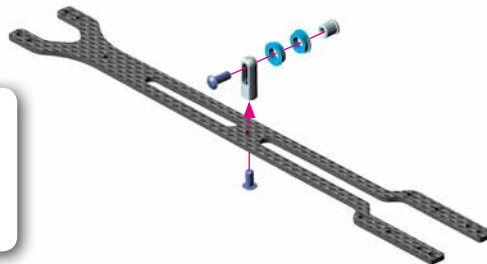

DETAIL

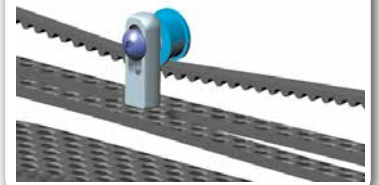

902306
SH M3x6

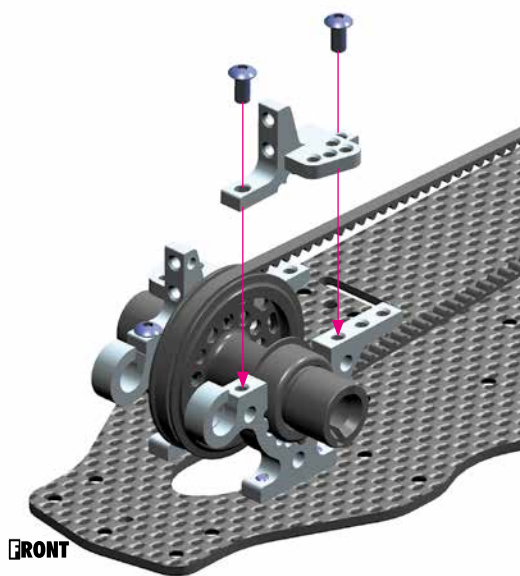

FRONT

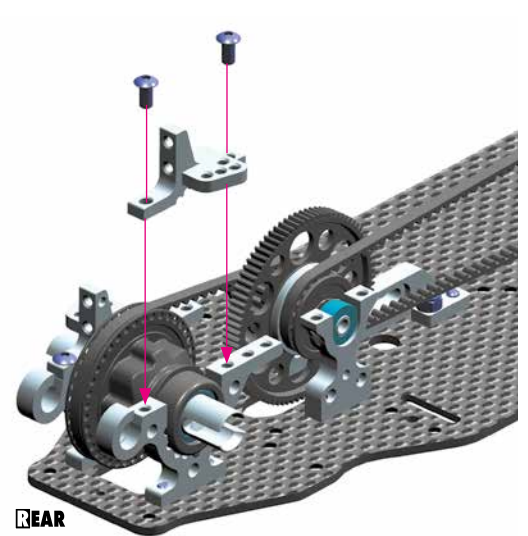

REAR



902306
SH M3x6

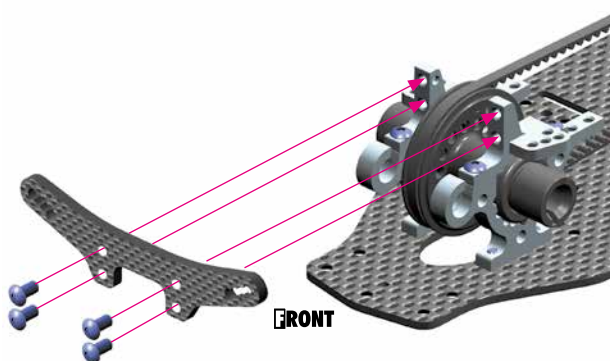

FRONT

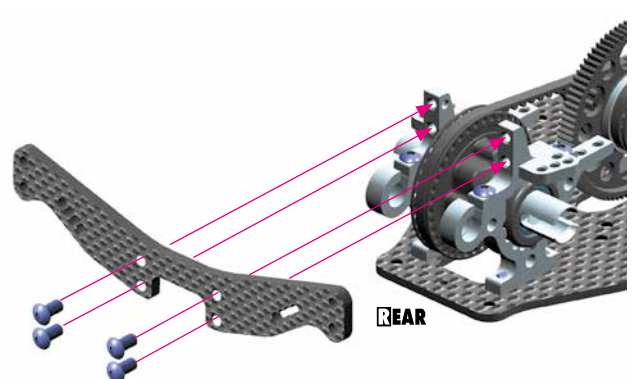

REAR

3. FRONT & REAR SUSPENSION

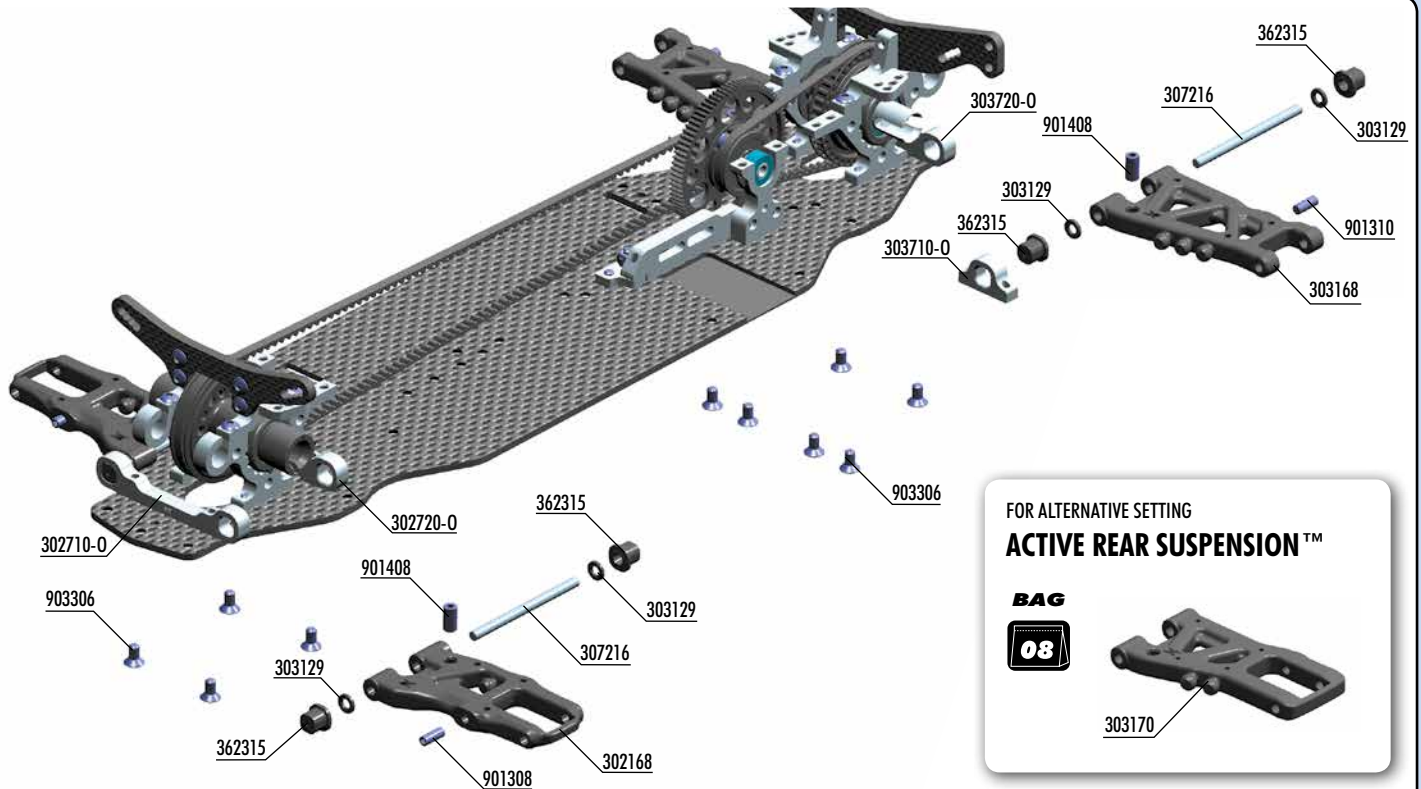

OPTIONAL



For better stability and to make the car easier to drive, optional #302190 and #303190 graphite stiffeners may be used. Using only 4 screws, the graphite stiffener can be installed or removed which would completely change the characteristics of the car. Stiffeners may be used independently at front and/or rear. **IMPORTANT!** Install/remove stiffeners equally on left & right sides.

GRAPHITE FRONT LOWER ARM PLATE 1.6MM (2)

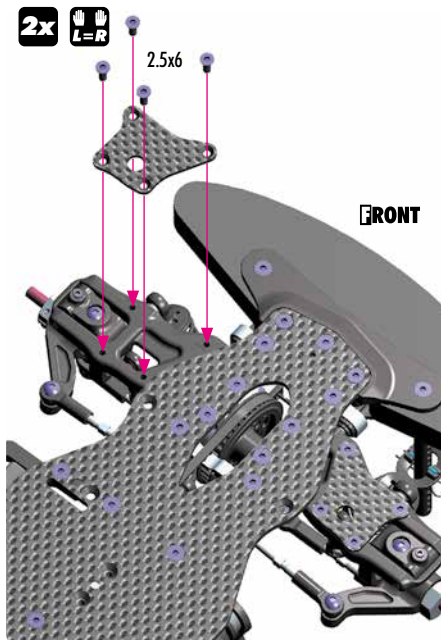

GRAPHITE REAR LOWER ARM PLATE 1.6MM (2)



STANDARD REAR SUSPENSION

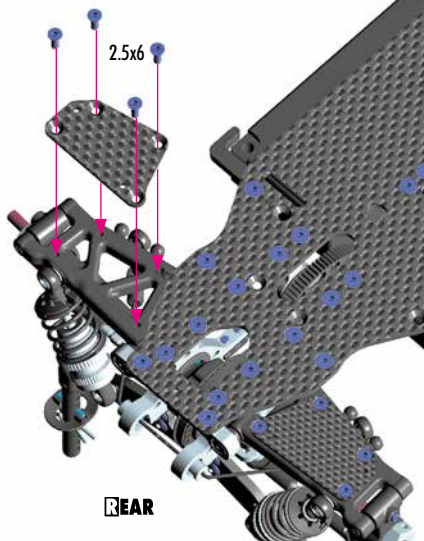

ARS GRAPHITE REAR LOWER ARM PLATE 1.6MM (2)



ACTIVE REAR SUSPENSION™

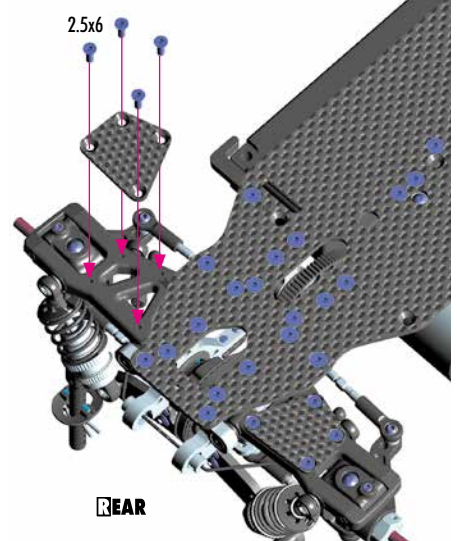

30 2168	FRONT SUSPENSION ARM - HARD - 1-HOLE	30 3192	ARS GRAPHITE REAR LOWER ARM PLATE 1.6MM (2) (OPTION)
30 2169	FRONT SUSPENSION ARM - GRAPHITE - 1-HOLE (OPTION)	30 3710-0	ALU LOWER 2-PIECE SUSPENSION HOLDER
30 2190	GRAPHITE FRONT LOWER ARM PLATE 1.6MM (2) (OPTION)	30 3711-0	ALU REAR LOWER 1-PIECE SUSPENSION HOLDER - FRONT - RF (OPTION)
30 2710-0	ALU FRONT LOWER 1-PIECE SUSPENSION HOLDER - FRONT - FF	30 3720-0	ALU REAR LOWER 1-PIECE SUSPENSION HOLDER - REAR - RR
30 2720-0	ALU FRONT LOWER 1-PIECE SUSPENSION HOLDER - REAR - FR	30 7216	SUSPENSION PIVOT PIN (2)
30 3129	COMPOSITE SET OF WHEELBASE SHIMS (3x1MM; 1x2MM) (2)	36 2315	ECCENTRIC BUSHING SET (2)
30 3168	REAR SUSPENSION ARM - HARD - 1-HOLE		
30 3169	REAR SUSPENSION ARM - GRAPHITE - 1-HOLE (OPTION)	90 1308	HEX SCREW SB M3x8 (10)
30 3170	ARS - ACTIVE REAR SUSPENSION ARM - HARD - 1-HOLE	90 1310	HEX SCREW SB M3x10 (10)
30 3171	ARS - ACTIVE REAR SUSPENSION ARM - GRAPHITE - 1-HOLE (OPTION)	90 1408	HEX SCREW SB M4x8 (10)
30 3190	GRAPHITE REAR LOWER ARM PLATE 1.6MM (2) (OPTION)	90 3306	HEX SCREW SFH M3x6 (10)

3. FRONT & REAR SUSPENSION



901310
SB M3x10



901408
SB M4x8

REAR ARMS

STANDARD REAR SUSPENSION

INITIAL SETTING

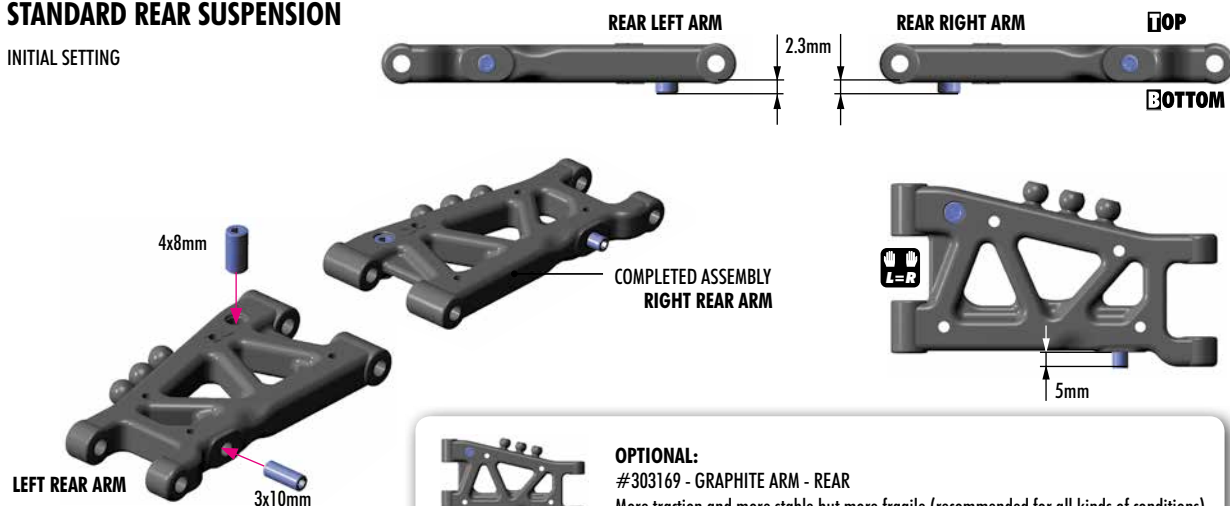

ACTIVE REAR SUSPENSION™

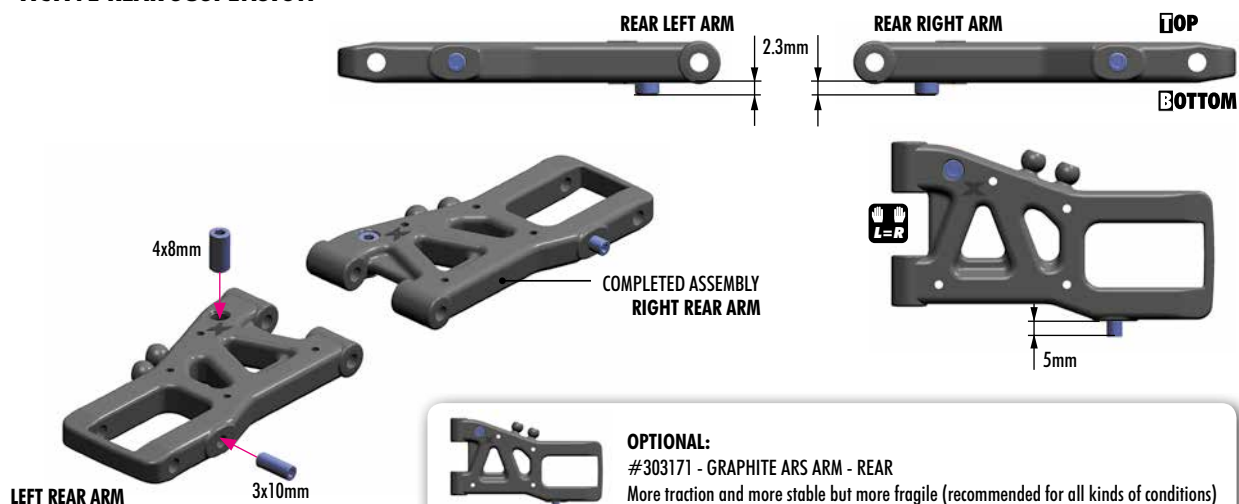

REAR DOWNSTOP
ADJUSTMENT



901308
SB M3x8



901408
SB M4x8

FRONT ARMS

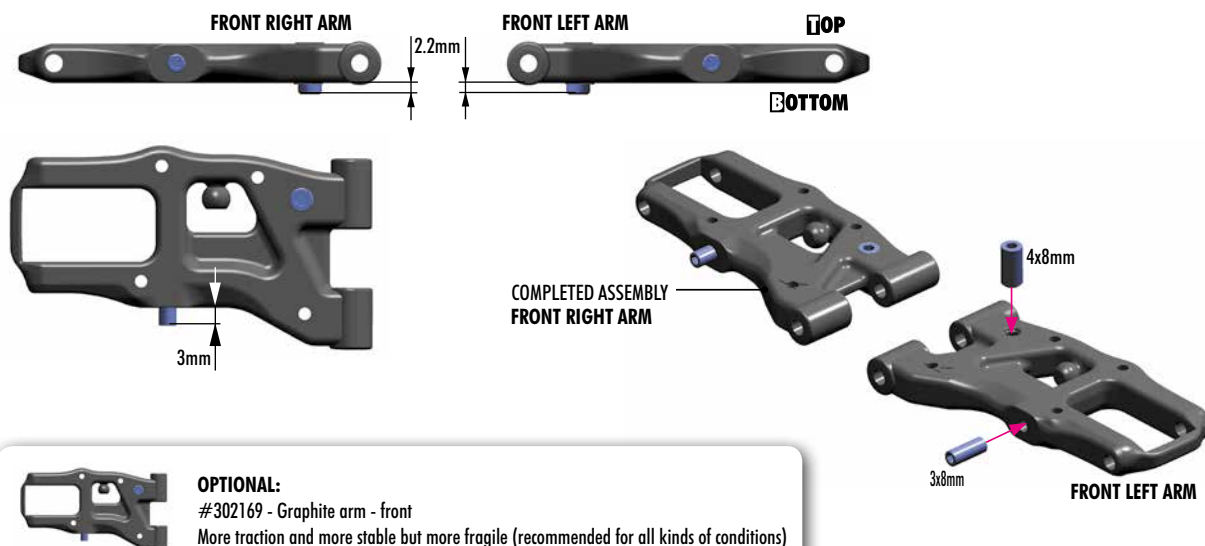

FRONT DOWNSTOP
ADJUSTMENT

3. FRONT & REAR SUSPENSION



903306
SFH M3x6

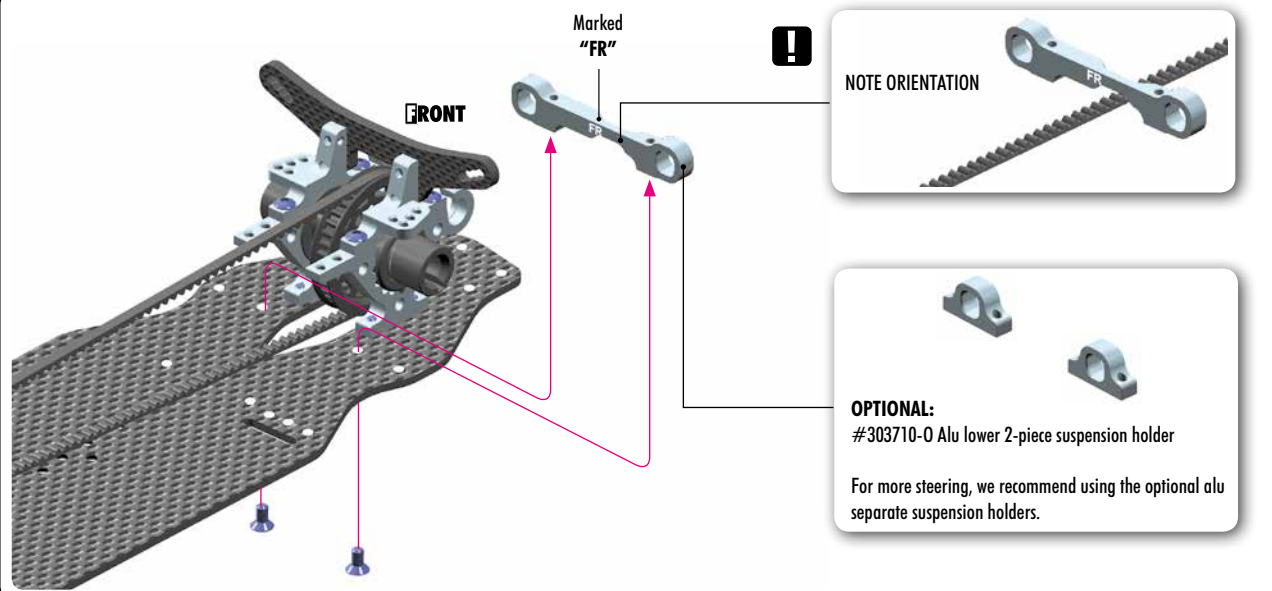

10

303129
SHIM 3x6x1



903306
SFH M3x6

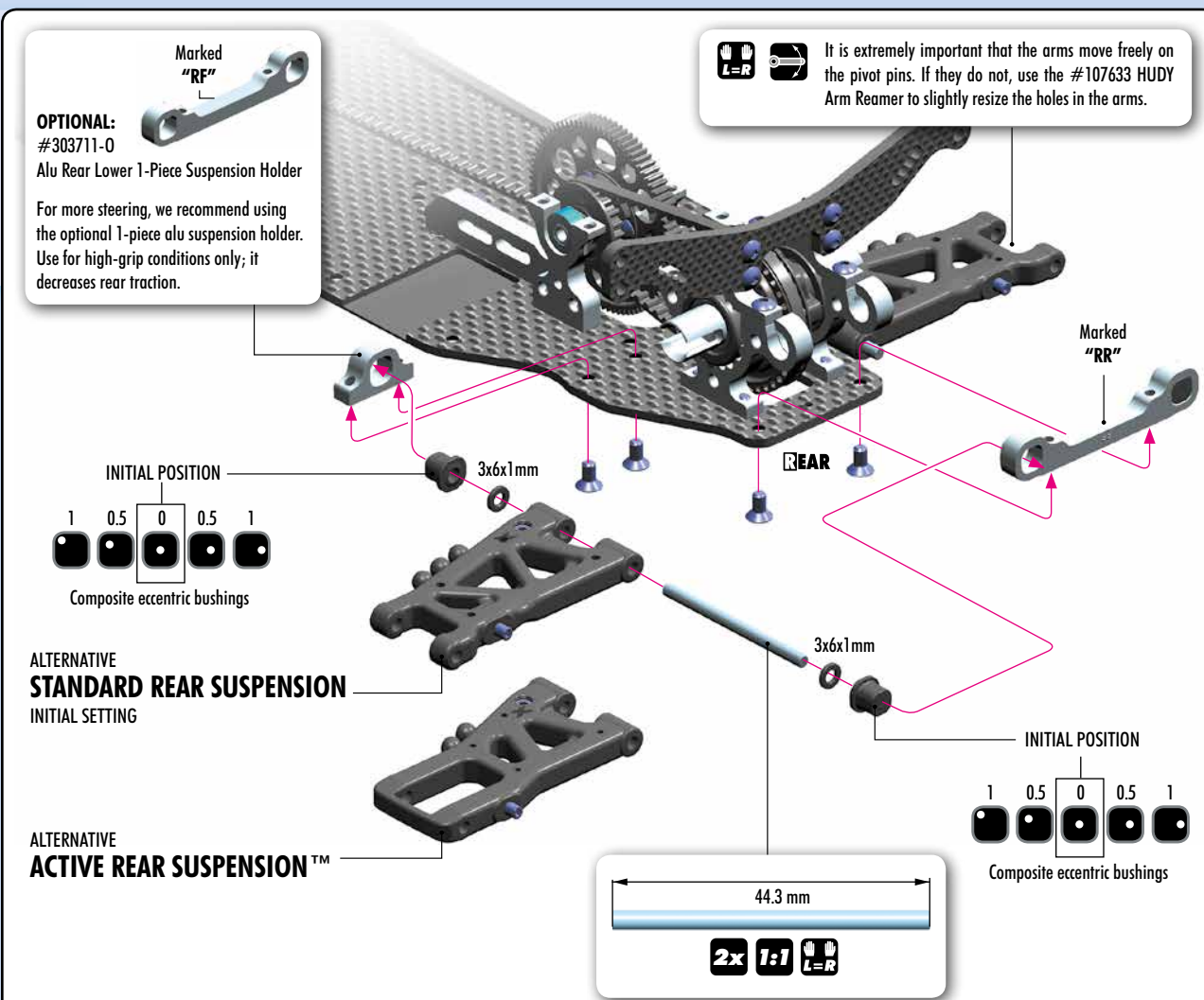

ECCENTRIC BUSHINGS HAVE TWO DIFFERENT OFFSETS FROM THE CENTER.

● Middle position = 0.5 mm or 0.5° from center ● Outer position = 1 mm or 1° from center

The new Xray rear alu lower suspension holders provide even greater range of adjustment for the rear suspension. Using different combinations of eccentric bushings, fine adjustment of rear squat, rear toe-in, rear roll center, and rear track-width can be obtained. For more information about the influence of rear squat, rear toe-in, rear roll center and rear track-width on car handling, please refer to HUDY Set-up Book (#209100).

All possible mounting alternatives of eccentric bushings

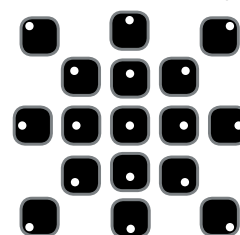

TOE-IN
TRACK-WIDTH
WHEELBASE
ROLL CENTER
ANTI-SQUAT
PRO-SQUAT

903306
SEH M3v6

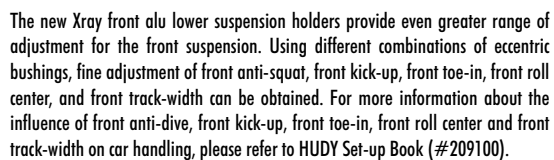
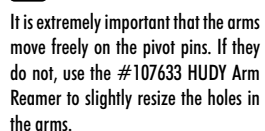

4. STEERING

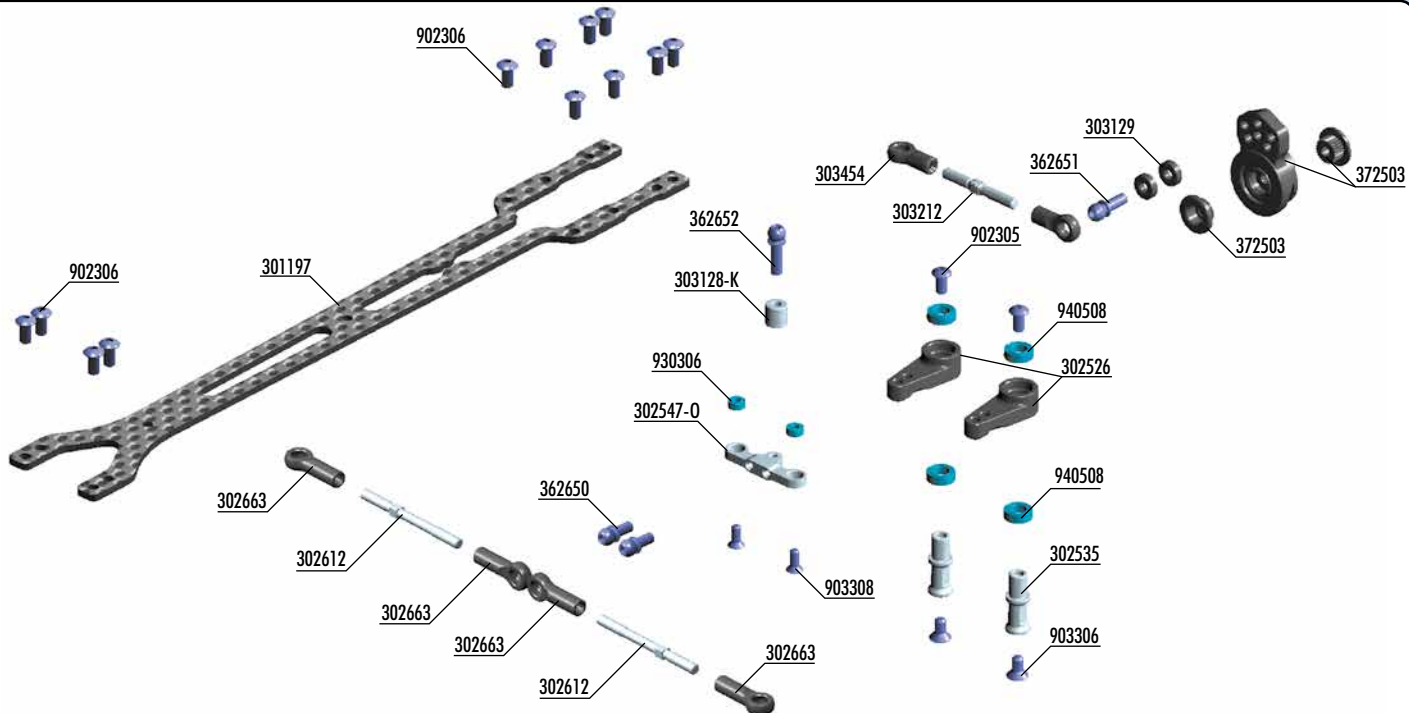

- | | | | |
|-----------|--|---------|---|
| 30 1196 | T4 UPPER DECK 1.6MM GRAPHITE - V2 (OPTION) | 36 2650 | BALL END 4.9MM WITH THREAD 6MM (2) |
| 30 1197 | T4 UPPER DECK 2.0MM GRAPHITE | 36 2651 | BALL END 4.9MM WITH THREAD 8MM (2) |
| 30 2525 | ALU DUAL SERVO SAVER ARM + BALL-BEARINGS (2) (OPTION) | 36 2652 | BALL END 4.9MM WITH THREAD 10MM (2) |
| 30 2526 | COMPOSITE DUAL SERVO SAVER ARM | 37 2503 | COMPOSITE SERVO SAVER - X-STIFF - SET - V2 |
| 30 2535 | ALU STEERING POST FOR DUAL SERVO SAVER (2) | | |
| 30 2547-0 | T4*14 ALU STEERING PLATE 8.5MM FOR DUAL SERVO SAVER - ORANGE | 90 2305 | HEX SCREW SH M3x5 (10) |
| 30 2612 | ALU ADJ. TURNBUCKLE M3 L/R 39 MM - SWISS 7075 T6 (2) | 90 2306 | HEX SCREW SH M3x6 (10) |
| 30 2663 | COMPOSITE BALL JOINT 5 MM - OPEN - V2 (8) | 90 3306 | HEX SCREW SFH M3x6 (10) |
| 30 3128-K | ALU SHIM 3x6x6.0MM - BLACK (10) | 90 3308 | HEX SCREW SFH M3x8 (10) |
| 30 3129 | COMPOSITE SET OF SHIMS (3x1mm; 1x2mm) (2) | 93 0306 | BALL-BEARING 3x6x2.5 (2) |
| 30 3212 | ALU ADJ. TURNBUCKLE L/R 26 MM - SWISS 7075 T6 (2) | 94 0508 | HIGH-SPEED BALL-BEARING 5x8x2.5 RUBBER SEALED (2) |
| 30 3454 | BALL JOINT 4.9MM - OPEN (4) | | |

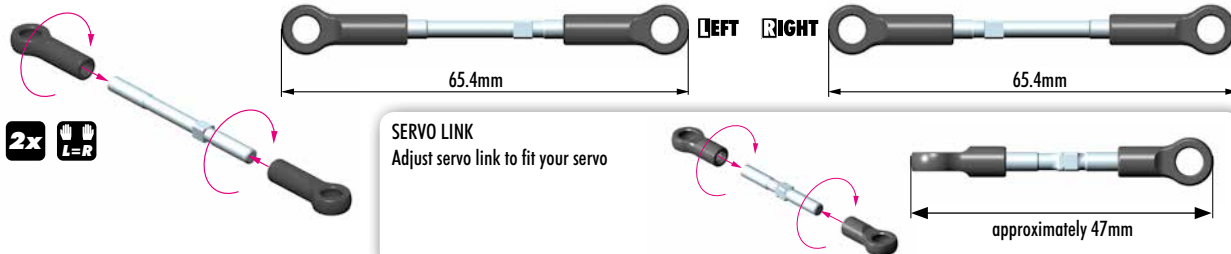

OPTIONAL:
#302525 - Alu Dual Servo Saver Arm

We recommend using the aluminum dual servo saver arms when better steering response is needed. Also recommended for asphalt tracks.

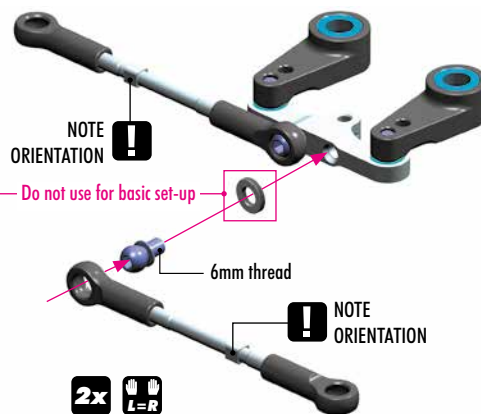

IO

303129
SHIM 3x6x2



303128-K
SHIM 3x6x6

HUDY ALU SERVO HORNS

#293491	KO, JR, Sanwa, Airtr. - OFFSET - 23T
#293492	Hitec - OFFSET - 24T
#293493	Futaba - OFFSET - 25T
#293501	KO, JR, Sanwa, Airtronics - 23T
#293502	Hitec - 24T
#293503	Futaba - 25T

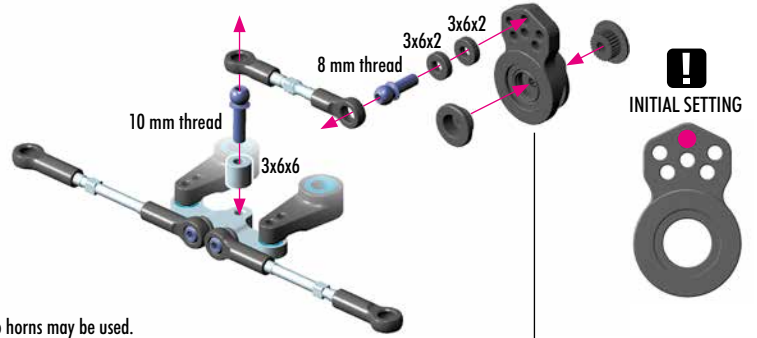

For more in-corner steering and better steering response, aluminum servo horns may be used.

IMPORTANT!

When the aluminum horn is used, the steering servo saver is not used. This increases the risk of breaking the servo in serious crashes.

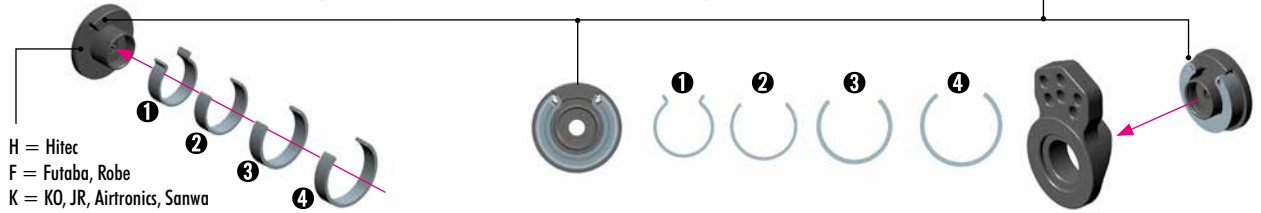

H = Hitec
F = Futaba, Robe
K = KO, JR, Airtronics, Sanwa



902305
SH M3x5



903306
SFH M3x6

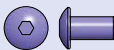
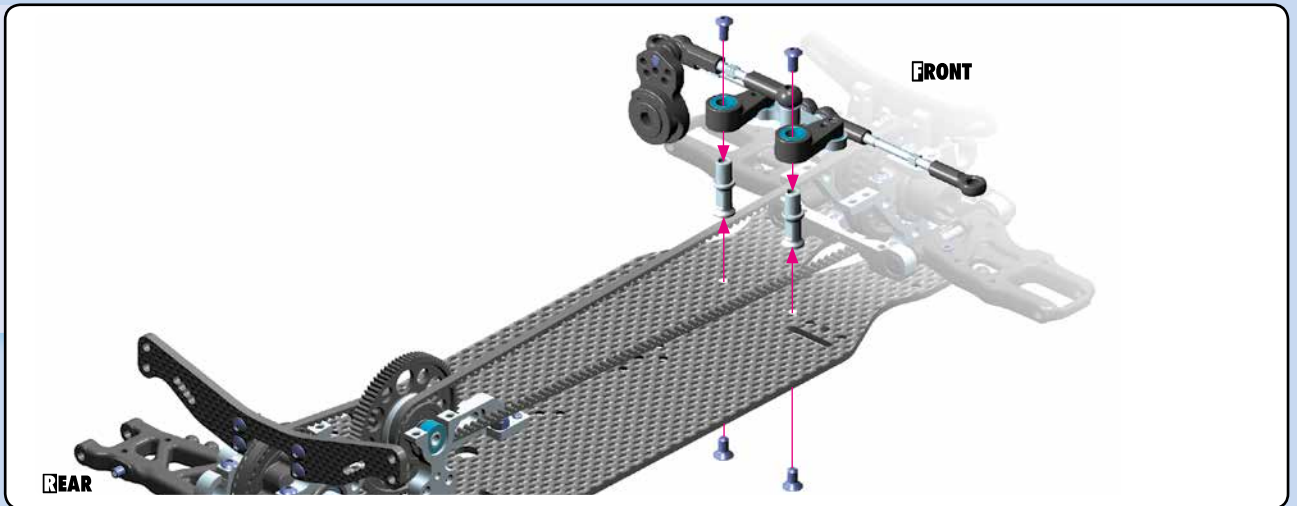

902306
SH M3x6

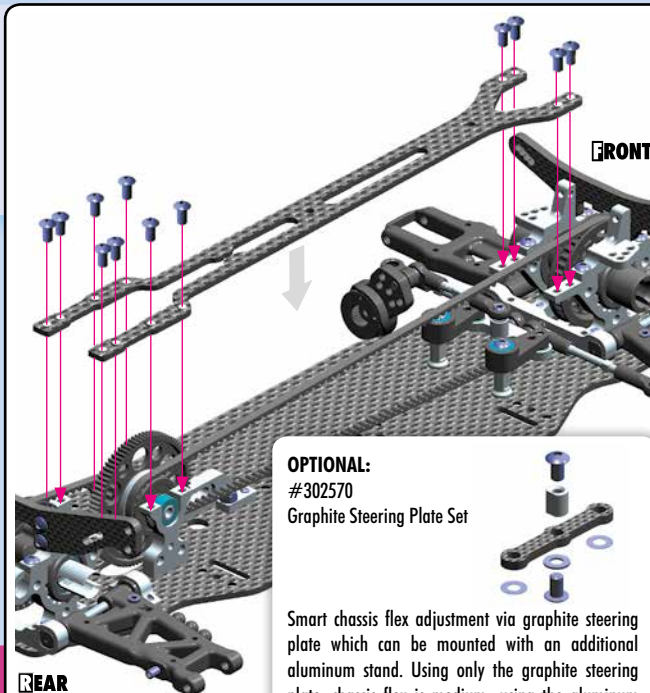

OPTIONAL:

#301196
T4 Graphite Upper Deck 1.6mm - V2

We recommend using optional 1.6mm top deck for super-low traction conditions as it provides more overall traction and steering.

OPTIONAL:

#306516-0
T4 Alu Top Deck Mount - Orange

Optional alu top deck mount improves forward and rear traction and makes the car more stable and easier to drive under low-traction conditions, however generates more on-power push. Recommended for low and medium traction conditions.

When the aluminum top deck mount is used, the screws from layshaft bulkheads and M3 nut from motor holder must be removed.

OPTIONAL:

#302570
Graphite Steering Plate Set

Smart chassis flex adjustment via graphite steering plate which can be mounted with an additional aluminum stand. Using only the graphite steering plate, chassis flex is medium; using the aluminum stand for reinforcement, the flex becomes stiffer. Stiffer flex results in more aggressive handling and increased steering.



CHASSIS FLEX SETTING
TOP DECK SETTING

5. FRONT & REAR TRANSMISSION

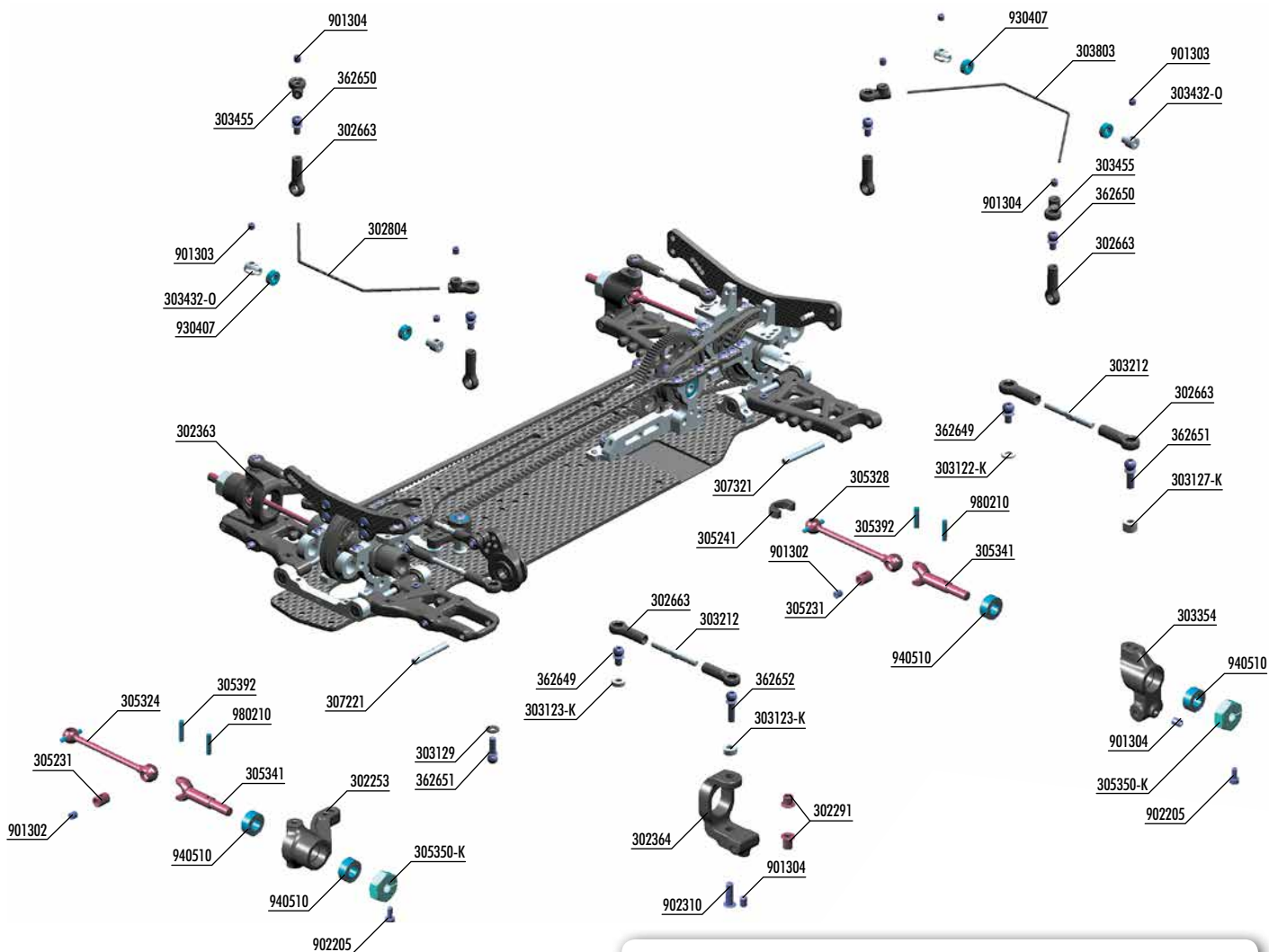

FOR ALTERNATIVE SETTING

ACTIVE REAR SUSPENSION™

BAG

08

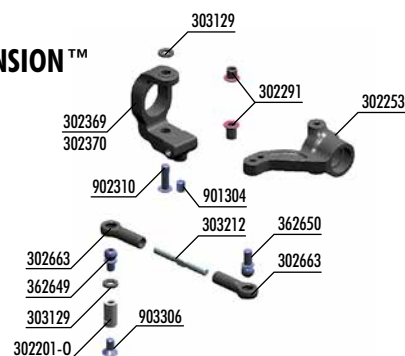

BAG

05

30 2201-0 ALU BRACE POST FOR ARS 3x5x9MM (2)
 30 2253 COMPOSITE STEERING BLOCK - HARD
 30 2291 STEEL STEERING BUSHING (2+2)
 30 2363 COMPOSITE C-HUB RIGHT - 4° DEG. - MEDIUM - V2
 30 2364 COMPOSITE C-HUB LEFT - 4° DEG. - MEDIUM - V2
 30 2369 COMPOSITE C-HUB RIGHT - 0° DEG. - HARD
 30 2370 COMPOSITE C-HUB LEFT - 0° DEG. - HARD
 30 2663 COMPOSITE BALL JOINT 4.9MM - OPEN - V2 (8)
 30 2804 ANTI-ROLL BAR FOR BALL BEARINGS - FRONT 1.4 MM
 30 3122-K ALU SHIM 3x6x1.0MM - BLACK (10)
 30 3123-K ALU SHIM 3x6x2.0MM - BLACK (10)
 30 3127-K ALU SHIM 3x6x4.0MM - BLACK (10)
 30 3129 COMPOSITE SET OF SHIMS (3x1MM; 1x2MM) (2)
 30 3210 TURNBUCKLE M3 L/R 26 MM - SPRING STEEL™ (2) (OPTION)
 30 3212 ALU ADJ. TURNBUCKLE M3 L/R 26 MM - SWISS 7075 T6 (2)
 30 3354 COMPOSITE UPRIGHT 0° OUTBOARD TOE-IN - HARD
 30 3432-0 ALU ANTI-ROLL BAR BUSHING - ORANGE (2)
 30 3455 COMPOSITE ANTI-ROLL BAR BALL JOINT 4.9 MM (4)
 30 3803 ANTI-ROLL BAR FOR BALL BEARINGS - REAR 1.3 MM
 30 5231 DRIVE SHAFT COUPLING - HUDY SPRING STEEL™
 30 5241 DRIVE SHAFT REPLACEMENT PLASTIC CAP 3.5 MM (4)
 30 5323 DRIVE SHAFT 50MM - HUDY SPRING STEEL™ (OPTION)
 30 5324 DRIVE SHAFT 52MM - HUDY SPRING STEEL™

30 5326 ALU DRIVE SHAFT SWISS 7075 T6 - HARDCOATED - 52MM (OPTION)
 30 5328 ALU DRIVE SHAFT SWISS 7075 T6 - HARDCOATED - 50MM
 30 5330 EQUALIZED CORNERING SPEED (ECS) DRIVE SHAFT 52MM (OPTION)
 30 5331 EQUALIZED CORNERING SPEED (ECS) DRIVE SHAFT 50MM (OPTION)
 30 5341 DRIVE AXLE - LIGHTWEIGHT - HUDY SPRING STEEL™
 30 5350-K ALU WHEEL HUB - BLACK (2)
 30 5392 DRIVE SHAFT PIN 2 x 10 WITH FLAT SPOT (2)
 30 7221 FRONT ARM PIVOT PIN (2)
 30 7321 REAR ARM PIVOT PIN (2)
 36 2649 BALL END 4.9MM WITH THREAD 5MM (2)
 36 2650 BALL END 4.9MM WITH THREAD 6MM (2)
 36 2651 BALL END 4.9MM WITH THREAD 8MM (2)
 36 2652 BALL END 4.9MM WITH THREAD 10MM (2)

90 1302 HEX SCREW SB M3x2.5 (10)
 90 1303 HEX SCREW SB M3x3 (10)
 90 1304 HEX SCREW SB M3x4 (10)
 90 2205 HEX SCREW SH M2x5 (10)
 90 2310 HEX SCREW SH M3x10 (10)
 90 3306 HEX SCREW SFH M3x6 (10)
 93 0407 BALL-BEARING 4x7x2.5 (2)
 94 0510 HIGH-SPEED BALL-BEARING 5x10x4 RUBBER SEALED (2)
 98 0210 PIN 2x10 (10)

5. FRONT & REAR TRANSMISSION



901302
SB M3x2.5



305392
P 2x10

4x



5

For easy installation of the #305241 plastic caps, use pliers as shown.

TIP

ECS DRIVE SHAFTS - OPTIONAL



ECS shafts are available optionally in both 50mm and 52mm lengths. The ECS drive shafts were developed to decrease front wheel vibration when racing with a solid front axle, thus providing a much smoother and quieter front ride and increased steering.

DRIVE SHAFTS

#305323	50MM - STEEL
#305324	52MM - STEEL
#305326	52MM - ALU
#305328	50MM - ALU
#305330	52MM - ECS
#305331	50MM - ECS

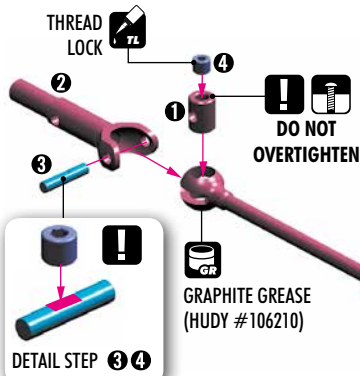

THREAD LOCK

DO NOT OVERTIGHTEN

GRAPHITE GREASE
(HUDY #106210)

DETAIL STEP 3 4

IMPORTANT!

DO NOT use the plastic caps with composite solid axle included in the kits.

3.5mm plastic caps are for use ONLY with GEAR diffs, ALU ball diffs, or the XRAY Multi-Diff™.

ONLY FOR REAR

Longer drive shafts (52mm) make the car easier to drive because they give more traction and better stability, mainly in chicanes. However, the car will understeer more than with shorter (50mm) shafts which give a lot of steering and impart aggression to the car.

Both left & right shafts should ALWAYS be the same length at one end of the car (front or rear).

52mm shafts are recommended for carpet and large asphalt tracks. 50mm shafts are recommended for small-medium tight asphalt tracks.



902205
SH M2x5



940510
BB 5x10x4



980210
P 2x10

REAR TRANSMISSION

ALTERNATIVE STANDARD REAR SUSPENSION INITIAL SETTING

2x **0° OUTBOARD TOE-IN UPRIGHTS**

Left UPRIGHT = Right UPRIGHT



Use alu 50mm Drive Shaft in rear

ALTERNATIVE ACTIVE REAR SUSPENSION™

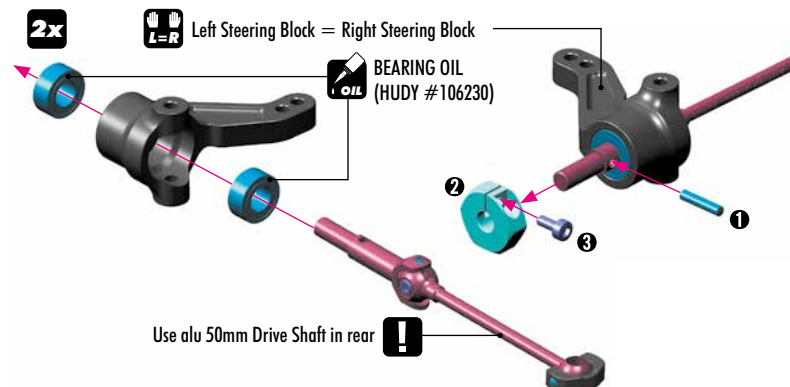

Use alu 50mm Drive Shaft in rear

T4 OPTIONAL PARTS



UPRIGHTS

#303351	1° - R - MEDIUM - 2-HOLE
#303352	0° - R/L - MEDIUM - 2-HOLE
#303353	1° - R - HARD - 2-HOLE
#303354	0° - R/L - HARD - 2-HOLE
#303361	1° - L - MEDIUM - 2-HOLE
#303362	0° - R/L - MEDIUM - 1-HOLE
#303363	1° - L - HARD - 2-HOLE
#303364	0° - R/L - HARD - 1-HOLE
#303358	ALU 1° - R/L - 4-HOLE
#303359	ALU 2° - R/L - 4-HOLE

STANDARD

STANDARD

WHEEL HUBS

#305350-K	ALU - OFFSET 0 MM
#305351	ALU - OFFSET -0.75 MM
#305352	ALU - OFFSET +0.75 MM
#305353	ALU - OFFSET +1.5 MM



STEERING BLOCKS

#302252	MEDIUM
#302253	HARD
#302256	ALU

STANDARD

SET-UP
BOOK

REAR TOE-IN
TRACK-WIDTH

5. FRONT & REAR TRANSMISSION



902205
SH M2x5



940510
BB 5x10x4



980210
P 2x10



REAR TOE-IN
TRACK-WIDTH

2x FRONT TRANSMISSION

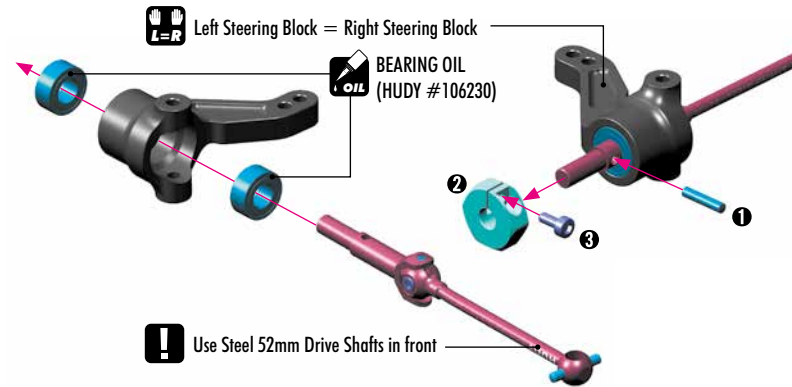

T4 OPTIONAL PARTS

WHEEL HUBS		
STANDARD	#305350-K	ALU - OFFSET 0 MM
	#305351	ALU - OFFSET -0.75 MM
	#305352	ALU - OFFSET +0.75 MM
	#305353	ALU - OFFSET +1.5 MM

STEERING BLOCKS		
	#302252	MEDIUM
STANDARD	#302253	HARD
	#302256	ALU



902310
SH M3x10



CASTER ADJUSTMENT

2x FRONT TRANSMISSION

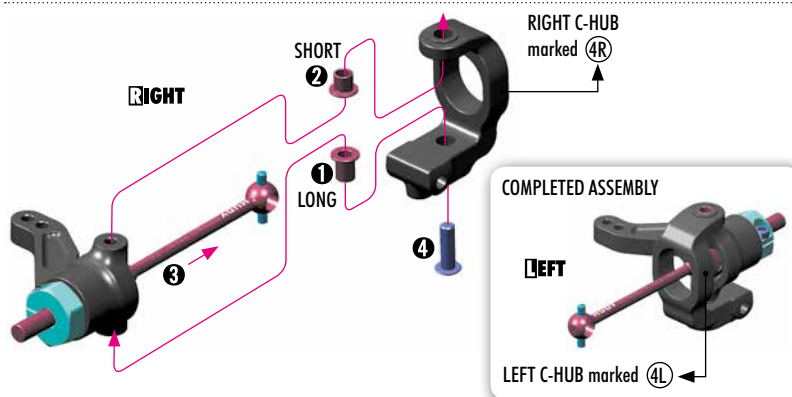

2x ACTIVE REAR SUSPENSION™

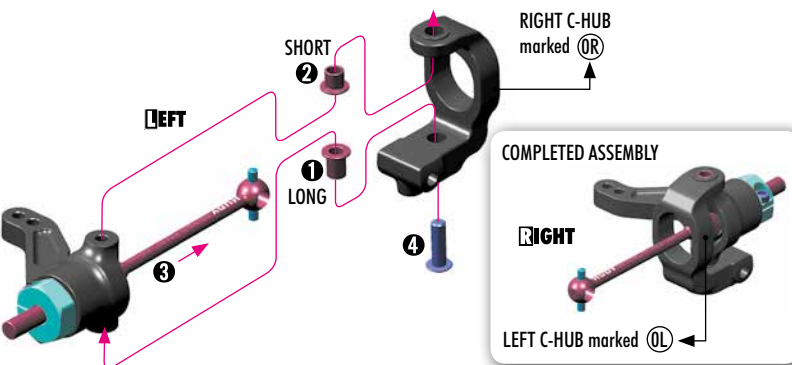

C-HUBS FRONT TRANSMISSION		
	#302334	ALU 0° - R + L
	#302335	ALU 2° - RIGHT
	#302336	ALU 2° - LEFT
	#302337	ALU 4° - RIGHT
	#302338	ALU 4° - LEFT
	#302339	ALU 6° - RIGHT
	#302340	ALU 6° - LEFT
	#302361	2° - RIGHT - MEDIUM
	#302362	2° - LEFT - MEDIUM
STANDARD	#302363	4° - RIGHT - MEDIUM
STANDARD	#302364	4° - LEFT - MEDIUM
	#302365	6° - RIGHT - MEDIUM
	#302366	6° - LEFT - MEDIUM
	#302371	2° - RIGHT - HARD
	#302372	2° - LEFT - HARD
	#302373	4° - RIGHT - HARD
	#302374	4° - LEFT - HARD
	#302375	6° - RIGHT - HARD
	#302376	6° - LEFT - HARD
	#302383	4° - RIGHT - GRAPHITE
	#302384	4° - LEFT - GRAPHITE

C-HUBS ACTIVE REAR TRANSMISSION		
	#302334	ALU 0°
	#302359	0° - RIGHT - MEDIUM
	#302360	0° - LEFT - MEDIUM
STANDARD	#302369	0° - RIGHT - HARD
STANDARD	#302370	0° - LEFT - HARD
	#302379	0° - RIGHT - GRAPHITE
	#302380	0° - LEFT - GRAPHITE

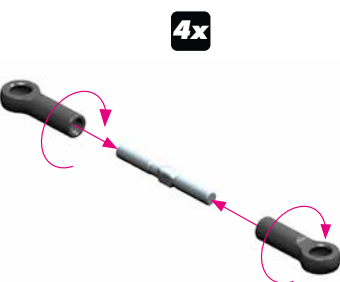

FRONT

2x L=R
FRONT LEFT = FRONT RIGHT



REAR

2x L=R
REAR LEFT = REAR RIGHT



CAMBER ADJUSTMENT

5. FRONT & REAR TRANSMISSION



303122-K
SHIM 3x6x1



303127-K
SHIM 3x6x4



901304
SB M3x4



REAR TRANSMISSION

ALTERNATIVE STANDARD REAR SUSPENSION INITIAL SETTING

LEFT UPRIGHT = RIGHT UPRIGHT

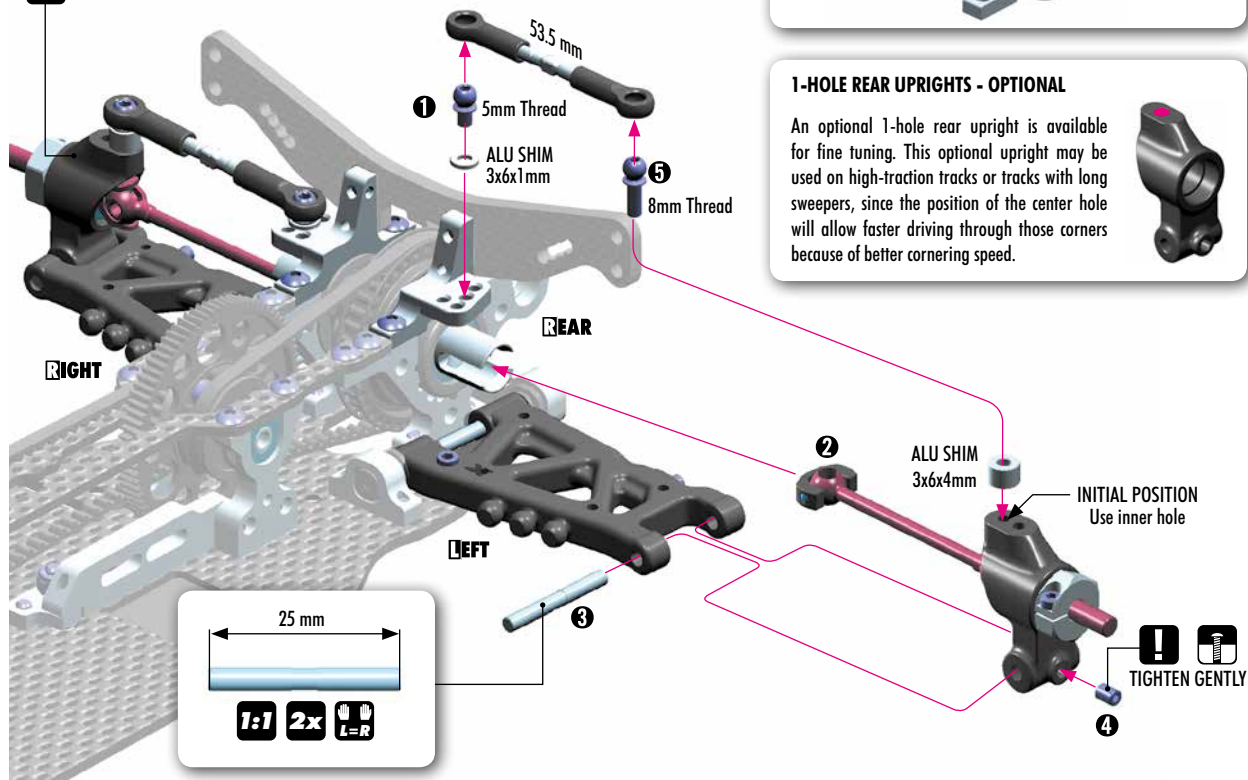

1-HOLE REAR UPRIGHTS - OPTIONAL

An optional 1-hole rear upright is available for fine tuning. This optional upright may be used on high-traction tracks or tracks with long sweepers, since the position of the center hole will allow faster driving through those corners because of better cornering speed.



303122-K
SHIM 3x6x1



303129
SHIM 3x6x1



901304
SB M3x4

ALTERNATIVE ACTIVE REAR SUSPENSION™

STEP 1

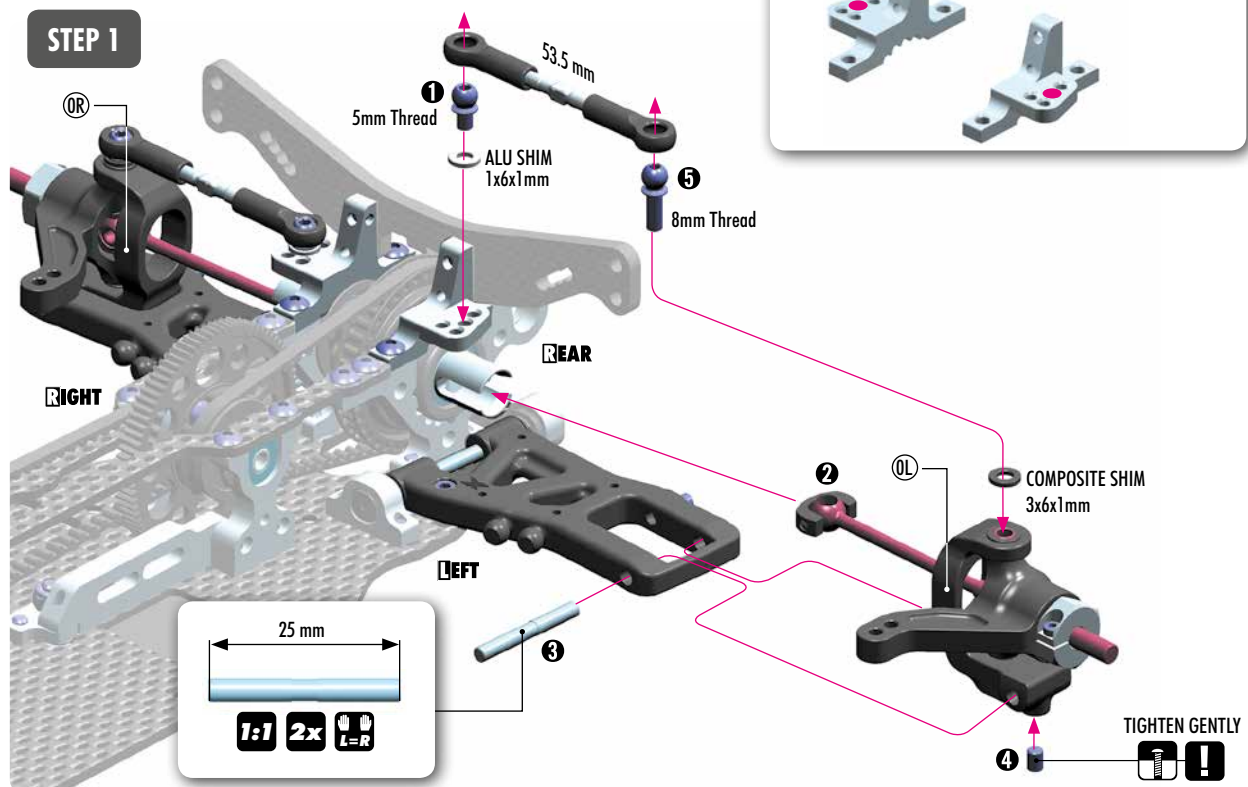

REAR ALU UPPER CLAMP INITIAL POSITION



ROLL CENTER

5. FRONT & REAR TRANSMISSION

10

303129
SHIM 3x6x1



903306
SFH M3x6

2x L=R REAR TRANSMISSION

ALTERNATIVE ACTIVE REAR SUSPENSION™

STEP 2

! IMPORTANT



The angle of ARS linkage – which is made by adding/removing shims on the steering block and ARS post mount – changes the toe-in characteristics of the rear tires under rolling effect; when the car is pressed the toe in can either increase or decrease.

Check the toe-in change on your set up system when the car is in neutral position and when is pressed to the floor. For more information see the HUDY Set-Up Book.

5mm THREAD
COMPOSITE SHIM 3x6x1mm
57 mm
6mm THREAD

INITIAL POSITION



! IMPORTANT
USE ALWAYS ONLY THIS POSITION

2x L=R

REAR LEFT = REAR RIGHT

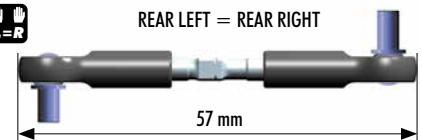

ACTIVE TOE-IN

303123-K
SHIM 3x6x2



901304
SB M3x4

2x L=R FRONT TRANSMISSION

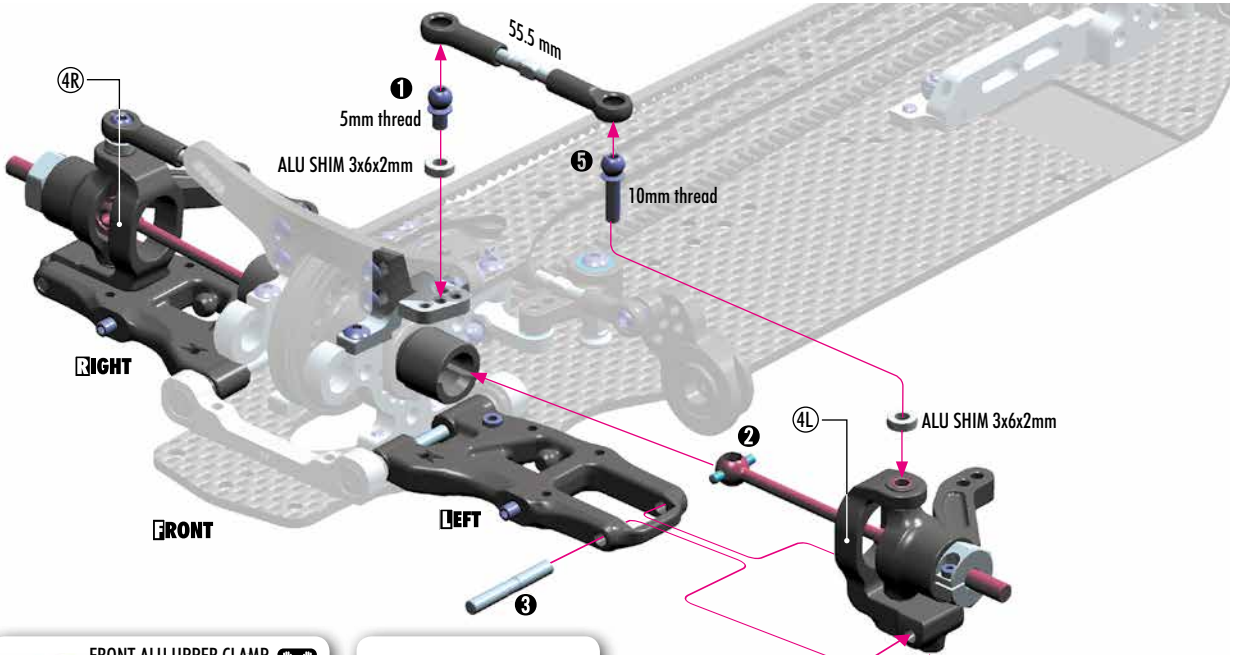

FRONT ALU UPPER CLAMP INITIAL POSITION



23 mm



1:1 2x L=R

! TIGHTEN GENTLY



ROLL-CENTER

5. FRONT & REAR TRANSMISSION

10
303129
SHIM 3x6x1

FRONT TRANSMISSION

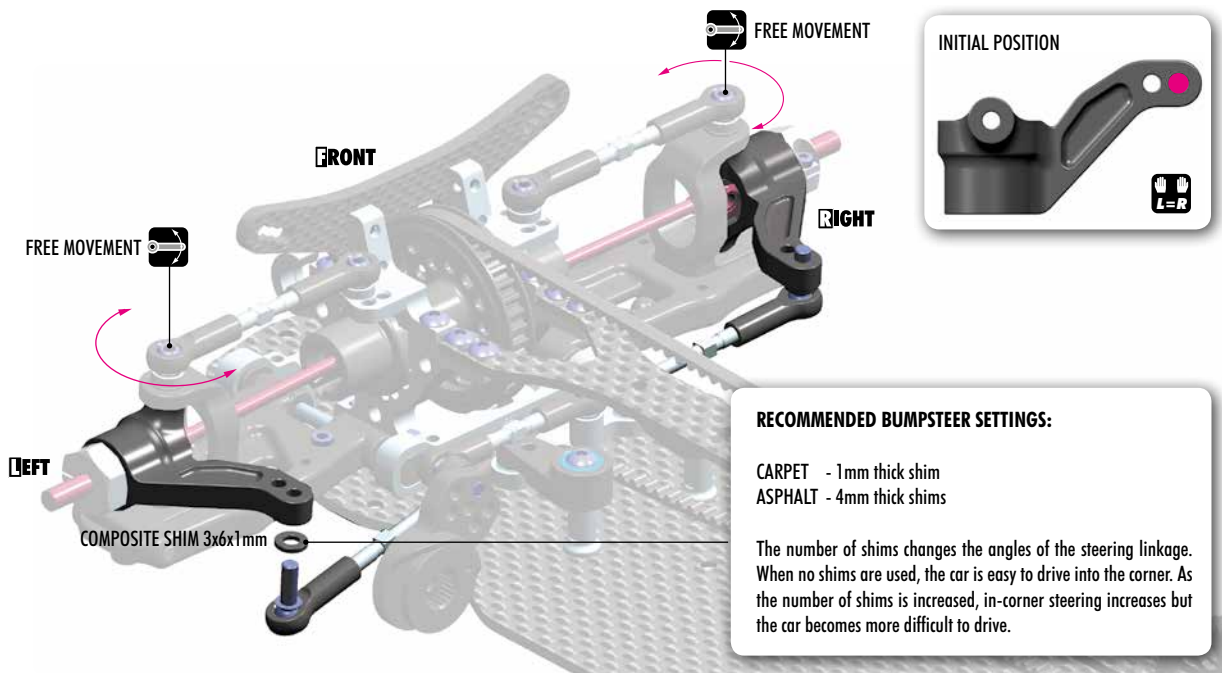

SET-UP
BOOK

ACKERMANN
BUMPSTEER

4x

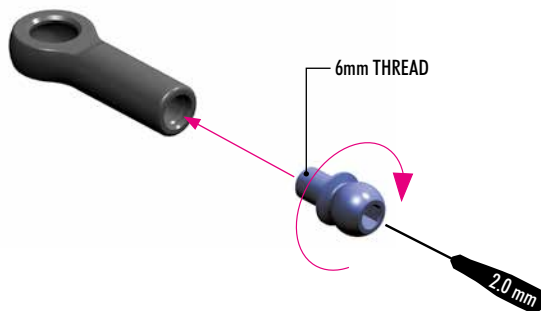

4x

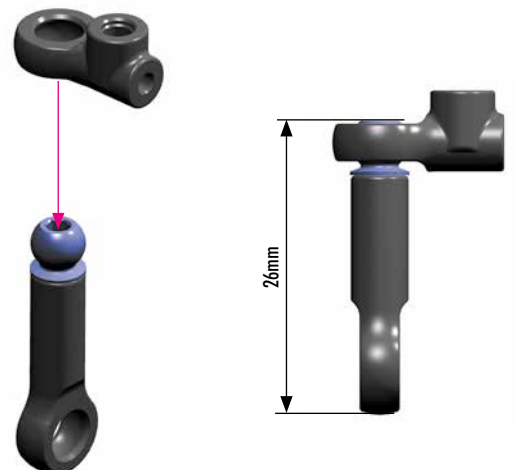

2x



STANDARD

FRONT ANTI-ROLL BARS	
#302802	FRONT 1.2 MM
#302803	FRONT 1.3 MM
#302804	FRONT 1.4 MM
#302805	FRONT 1.5 MM
#302806	FRONT 1.6 MM

STANDARD

REAR ANTI-ROLL BARS	
#303801	REAR 1.1 MM
#303802	REAR 1.2 MM
#303803	REAR 1.3 MM
#303804	REAR 1.4 MM
#303805	REAR 1.5 MM
#303806	REAR 1.6 MM

BEARING OIL
(HUDY #106230)

930407
BB 4x7x2.5

5. FRONT & REAR TRANSMISSION



FRONT ANTI-ROLL BAR

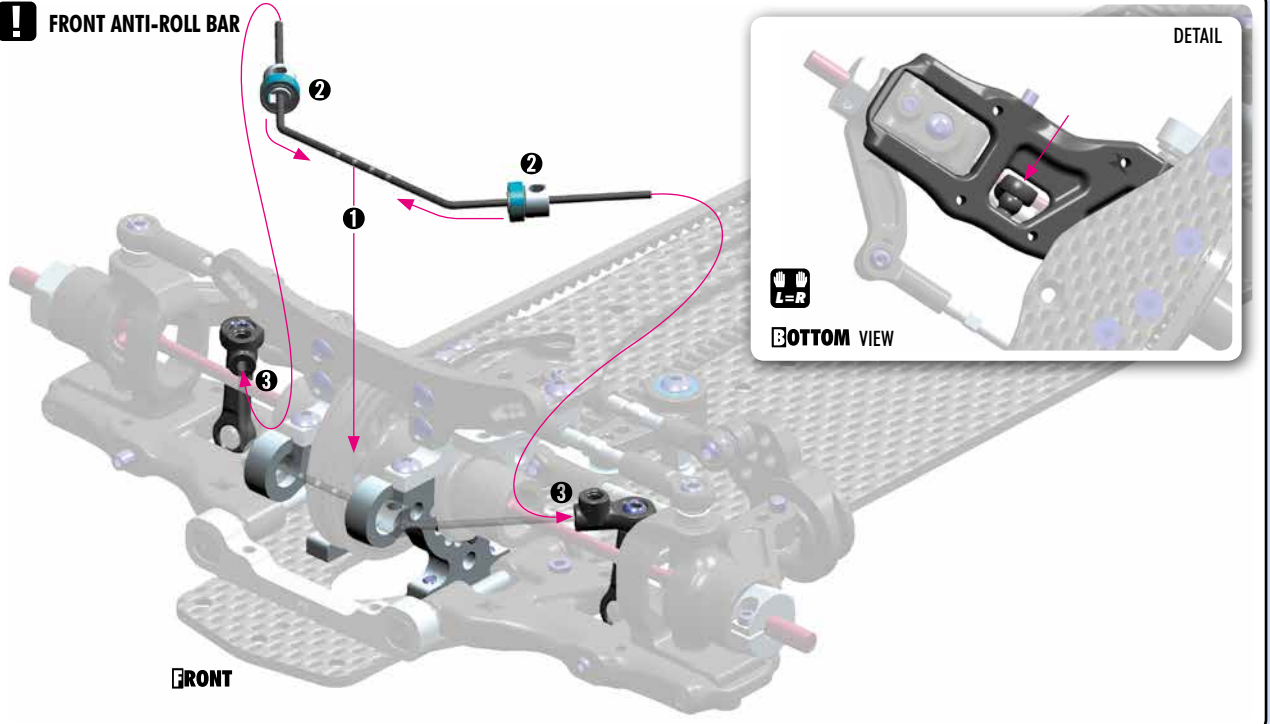

ANTI-ROLL BARS

901303
SB M3x3

901304
SB M3x4



FRONT ANTI-ROLL BAR

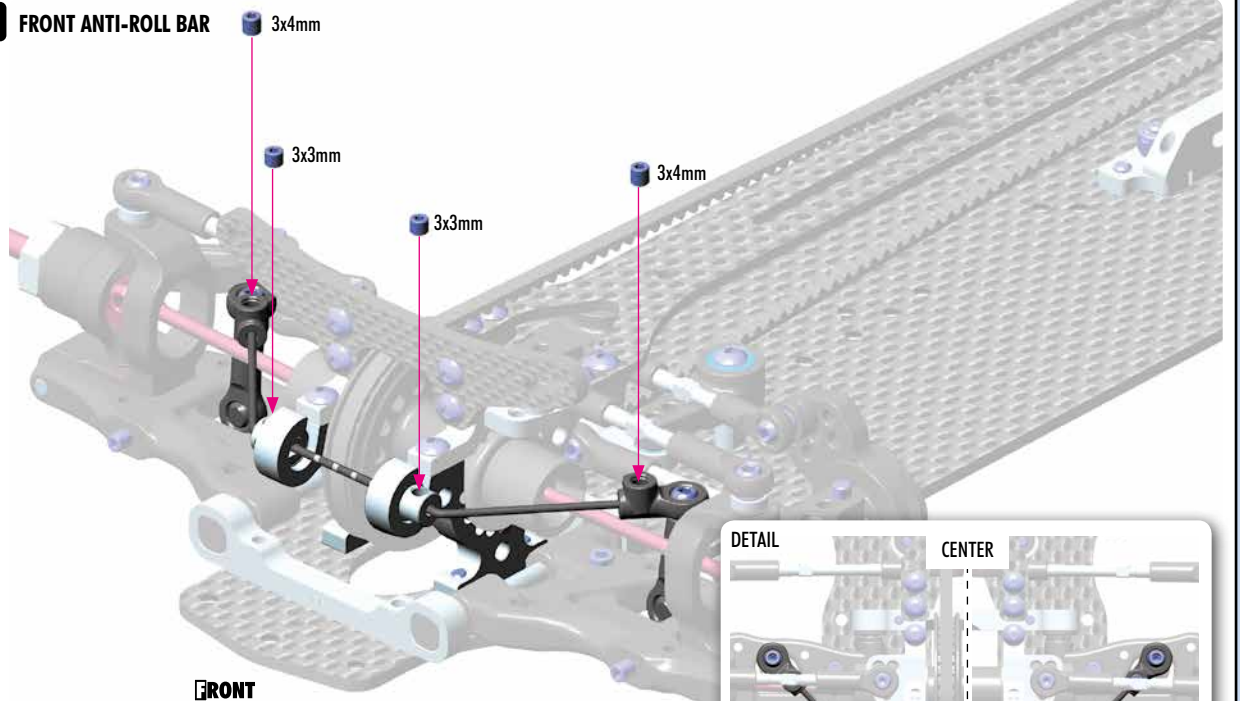

DETAIL

CENTER

TOP VIEW

FRONT

Set the bar into the center, remove the play in the bushings, and tighten the setscrews fully.

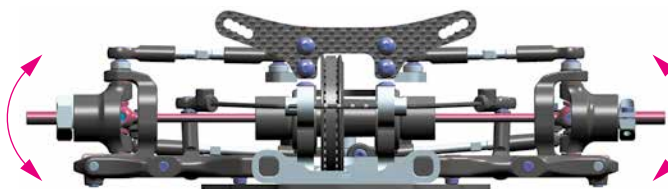

When the bars are set, verify that both sides move at the same time. If they do, the bars are set up correctly. If not, make sure that both downstops are the same and that the bar wire is flat.



If the sides still does not move at the same time, adjust the length of the bar holders.

5. FRONT & REAR TRANSMISSION

! REAR ANTI-ROLL BAR

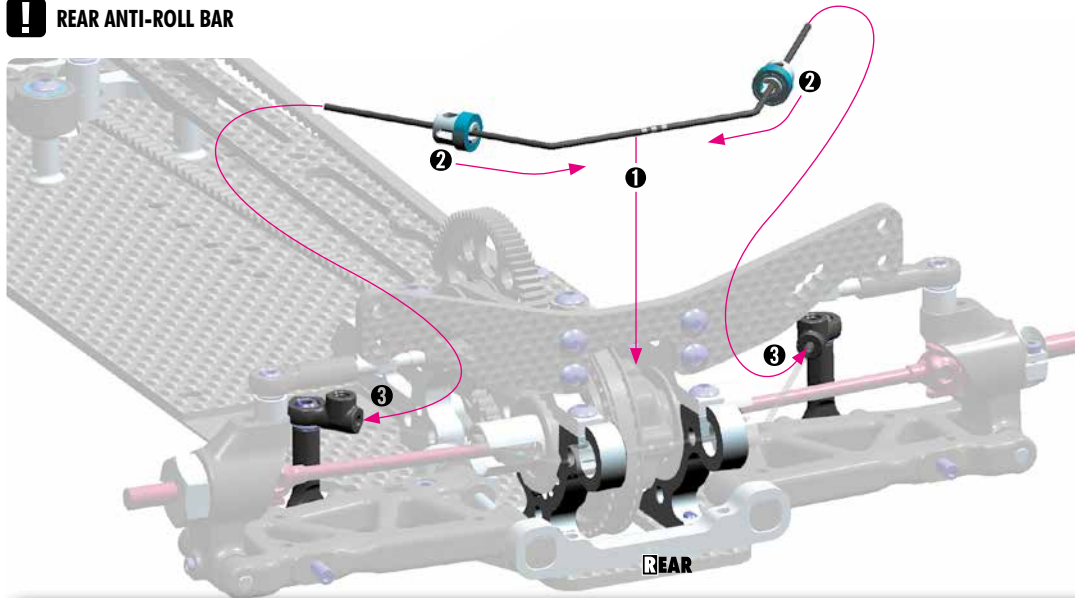

2x INITIAL POSITION

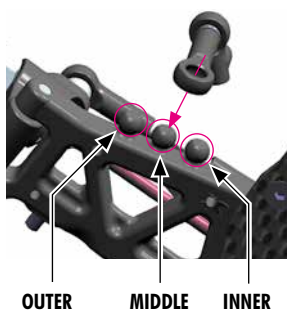

STANDARD SUSPENSION

INITIAL POSITION = MIDDLE BALL

Use the **INNER** ball on low-traction tracks (mainly low-traction carpet tracks). The car will have more traction & more steering, but will be more difficult to drive because the car will roll more.

Use the **MIDDLE** ball on low- to medium-traction tracks (asphalt, carpet). The car will have a little less rear traction and the car will roll a little less which will make it easier to drive with more cornering speed.

Use the **OUTER** ball on high-traction tracks (mainly high-traction asphalt tracks). The car will roll even less which will allow the use of more throttle in the corners, however the car will have less traction.

ACTIVE REAR SUSPENSION™

ARS arm has only two holes which are identical as inner and middle ball on the standard rear arm.

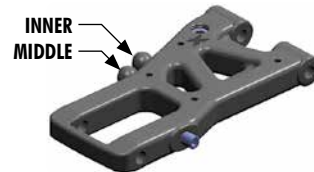

ANTI-ROLL BARS



901303
SB M3x3



901304
SB M3x4

! REAR ANTI-ROLL BAR

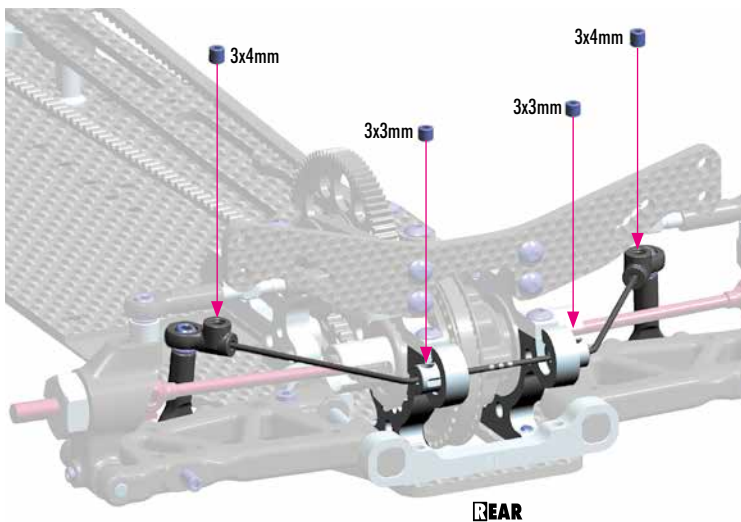

DETAIL

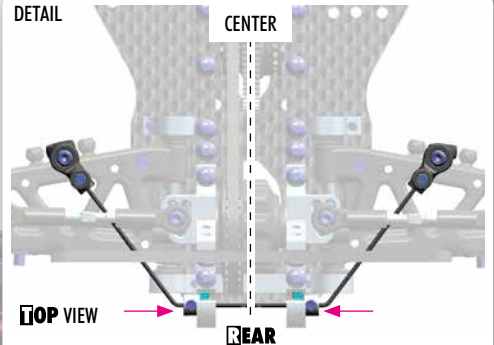

Set the bar into the center, remove the play in the bushings, and tighten the setscrews fully.

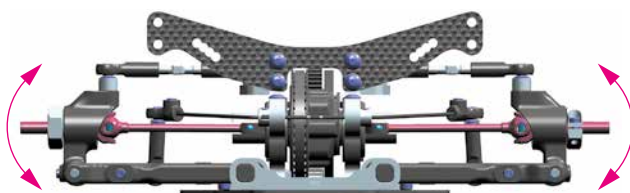

When the bars are set, verify that both sides move at the same time. If they do, the bars are set up correctly. If not, make sure that both downstops are the same and that the bar wire is flat.



If the sides still does not move at the same time, adjust the length of the bar holders.

6. SHOCK ABSORBERS

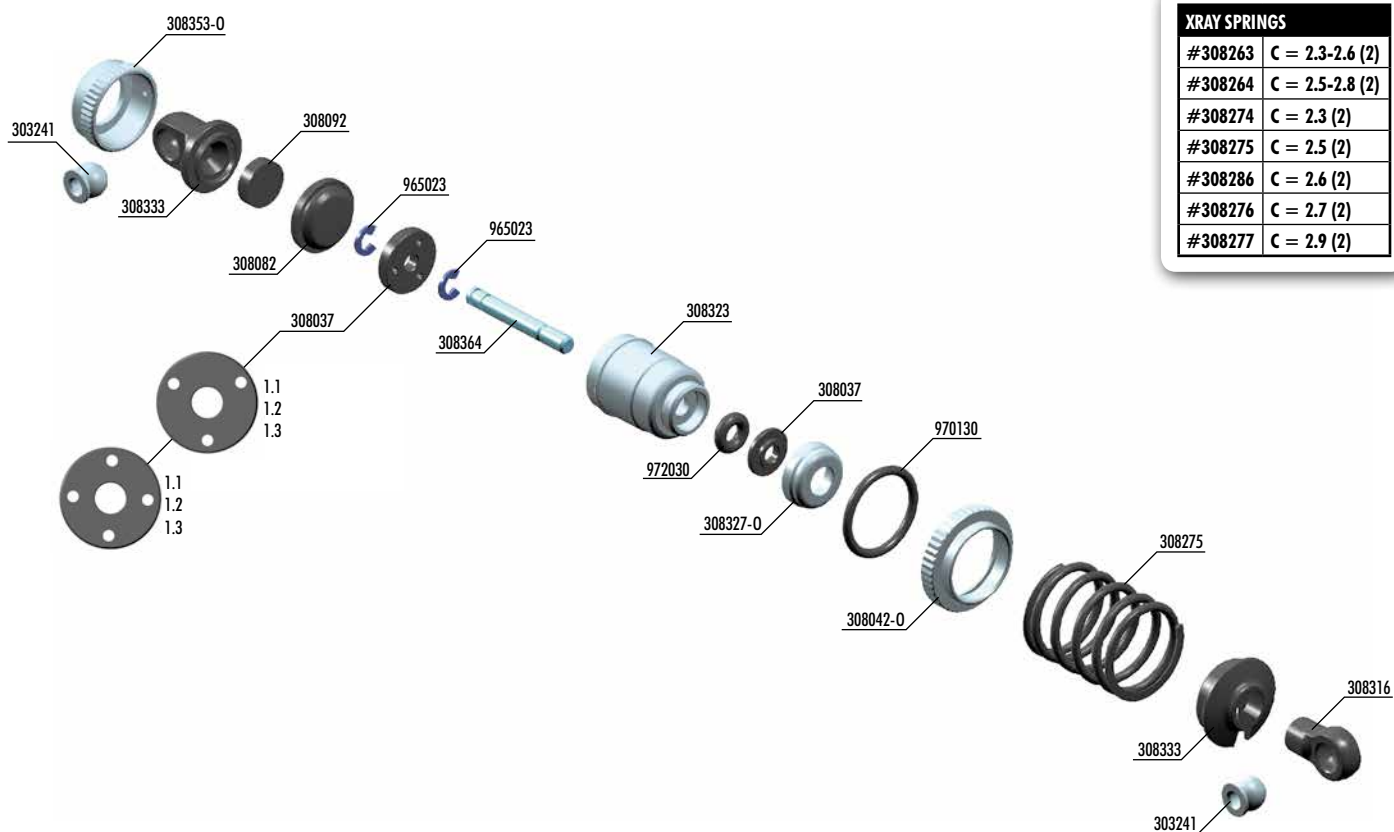

XRAY SPRINGS	
#308263	C = 2.3-2.6 (2)
#308264	C = 2.5-2.8 (2)
#308274	C = 2.3 (2)
#308275	C = 2.5 (2)
#308286	C = 2.6 (2)
#308276	C = 2.7 (2)
#308277	C = 2.9 (2)

BAG

06

30 3241 BALL UNIVERSAL 5.8 MM HEX (4)
 30 8037 COMPOSITE PISTONS 4-HOLE 1.0-1.2MM, 3-HOLE 1.0-1.2MM
 30 8042-0 T4 ALU SHOCK ADJUSTABLE NUT - ORANGE (2)
 30 8082 T4 SHOCK ABSORBER MEMBRANE (4)
 30 8092 T4 SHOCK FOAM INSERTS (4)
 30 8307-0 XRAY T4 ALU SHOCK ABSORBER-SET - ORANGE (2)
 30 8316 SHOCK BALL JOINT - OPEN (4)
 30 8323 T4 ALU XRAY SHOCK BODY (2)
 30 8327-0 ALU CAP FOR XRAY SHOCK BODY - ORANGE

30 8333 T4 COMPOSITE SHOCK PARTS FOR ALU SHOCKS
 30 8353-0 T4 ALU SHOCK CAP-NUT WITH VENT HOLE - ORANGE (2)
 30 8364 T4 HARDENED SHOCK SHAFT FOR ALU SHOCKS (2)
 30 8275 XRAY SPRING-SET C=2.5

96 5023 E-CLIP 2.3 (10)
 97 0130 O-RING 13 x 1.5 (10)
 97 2030 SILICONE O-RING 3 x 2 (10)



965023
C 2.3

4x

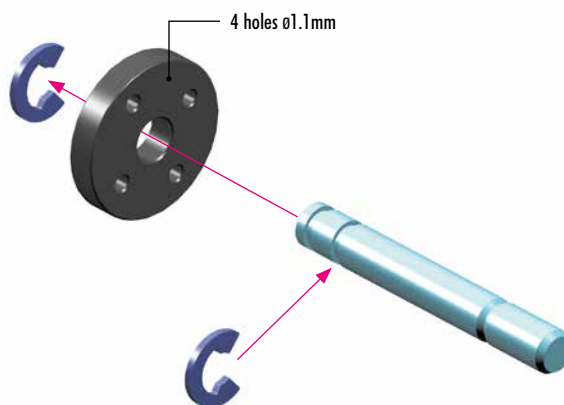

XRAY

6. SHOCK ABSORBERS



4x

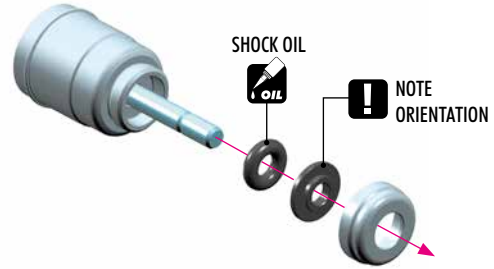
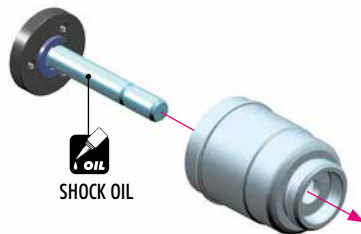

4x

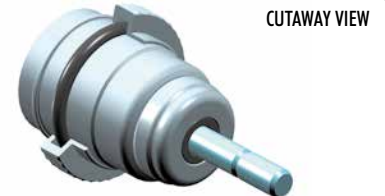
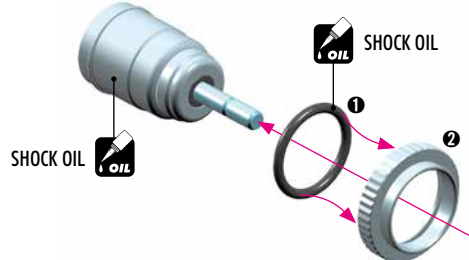

Be careful not to cross-thread the collar on the shock body.

4x

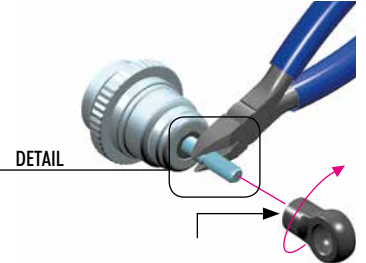
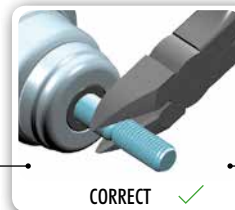
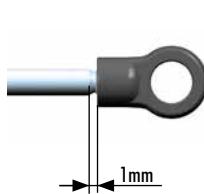

HINT: Pre-thread the ball joint using an M3 screw.

WARNING! Be careful not to pre-thread too far, since the ball joint may split or the plastic threads may strip out.

4x



SHOCK FILLING

- 1 Fully extend the piston rod so the piston is at the bottom of the shock body.
- 2 Hold the shock upright and slightly overfill the shock body with shock oil.
- 3 Let the oil settle and allow air bubbles to rise to the top. Slowly move the piston up and down to allow oil into all cavities within the shock body.
- 4 Extend the piston rod most of the way out of the shock body. Let the shock rest for 5 minutes to allow the air bubbles to escape.
- 5 Add shock oil as necessary.



4x

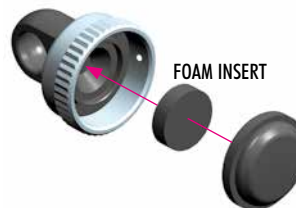
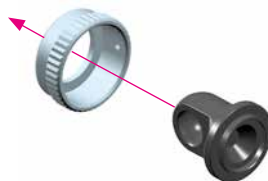

CUTAWAY VIEW



After you insert the membrane, ensure that it is fully seated inside the alu cap.

4x



When installing the shock cap assembly on the shock body, some oil will leak out... this is normal.

Tighten the cap and clean off any excess oil.

After the shock is assembled, the shock rod will push itself out of the shock body fairly quickly.

Follow the next procedure to adjust the rebound.

SHOCK OILS

#106310	100cSt	#106345	450cSt
#106315	150cSt	#106350	500cSt
#106320	200cSt	#106355	550cSt
#106325	250cSt	#106360	600cSt
#106330	300cSt	#106370	700cSt
#106335	350cSt	#106380	800cSt
#106340	400cSt	#106390	900cSt
		#106410	1000cSt
		#106420	2000cSt



6. SHOCK ABSORBERS

REBOUND ADJUSTMENT

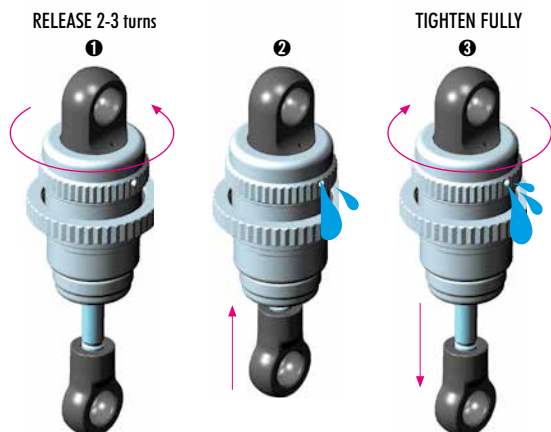

AFTER THE SHOCK IS ASSEMBLED YOU HAVE TO SET THE SHOCK REBOUND:

- 1 Release the shock cap by 2-3 turns.
- 2 Push the shock shaft fully up. For the first time the extra oil will release through the hole in the alu cap-nut.
- 3 Tighten the shock cap. When tightening the shock cap, extra oil will again release through the hole in the alu cap - nut. When tightening, the shock shaft will push out from the shock body.

REBOUND CHECK

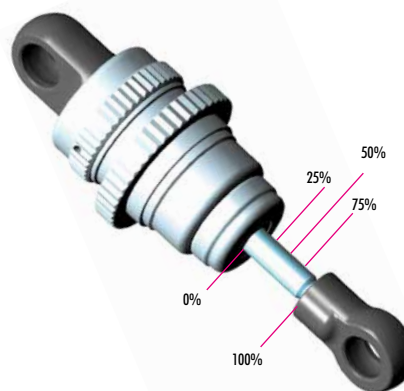

REBOUND CHECK:

It is very important to push the shock shaft into the shock body slowly otherwise air can come into the shock body which would create bubbles.

- | | |
|------|---|
| 100% | rebound - do not do step 2 and 3 |
| 75% | rebound - repeat step 2 and 3 until the shock shaft will push out 75% of its length |
| 50% | rebound - repeat step 2 and 3 until the shock shaft will push out 50% of its length |
| 25% | rebound - repeat step 2 and 3 until the shock shaft will push out 25% of its length |
| 0% | rebound - repeat step 2 and 3 until the shock shaft will push out 0% of its length |

If the shock shaft does not rebound enough, you will have to refill the shock with shock oil, and then repeat the bleeding and rebound adjustment procedure.

SHOCK LENGTH ADJUSTMENT:

It is VERY important that all shocks are equal length. Fully extend the shock absorber and measure the end-to-end length; we recommend using digital calipers to give an accurate measurement. If a shock absorber is shorter or longer than others, adjust the shock length by tightening or loosening the ball joint on the shock rod.

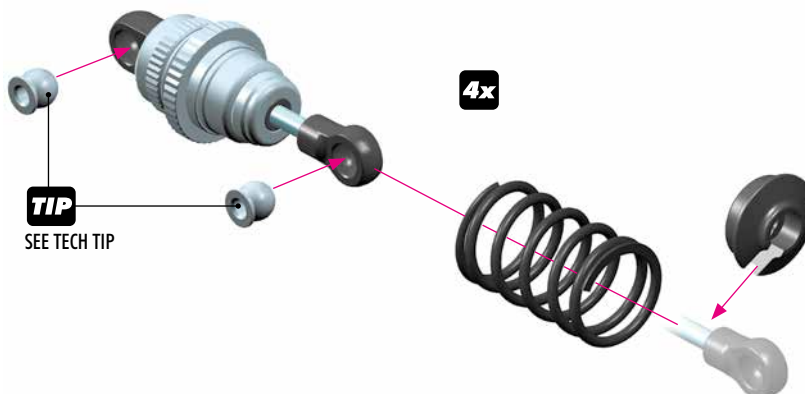

TECH TIP

Follow this tech tip to properly install pivot balls into the top pivot and bottom ball joint.

- Parts Needed:
- M3x16 SH screw
 - M3 shim

Note that the composite parts have two sides, noticeable around the pivot ball hole: one side has a shiny finish, the other side has a regular finish.

SHINY FINISH SIDE

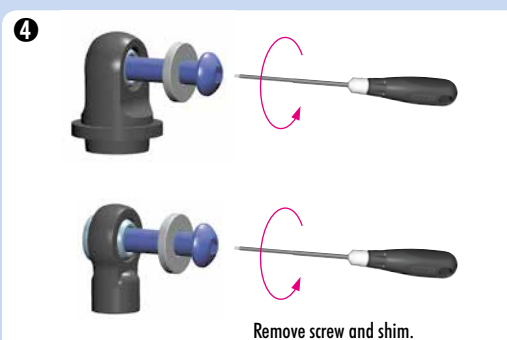
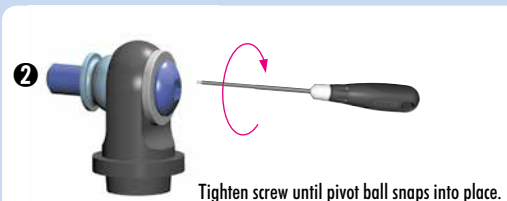
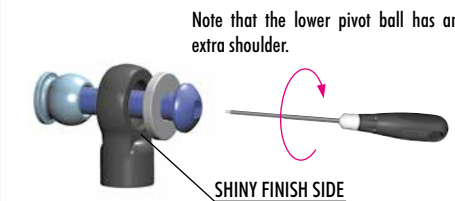
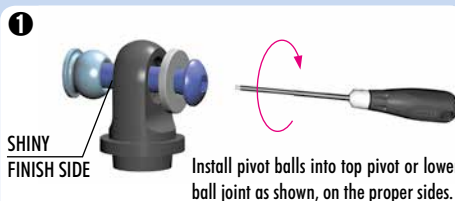
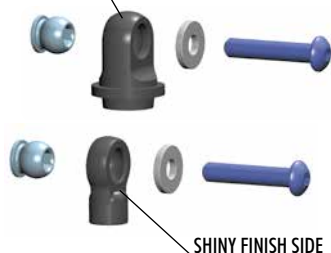

7. FRONT & REAR ASSEMBLY

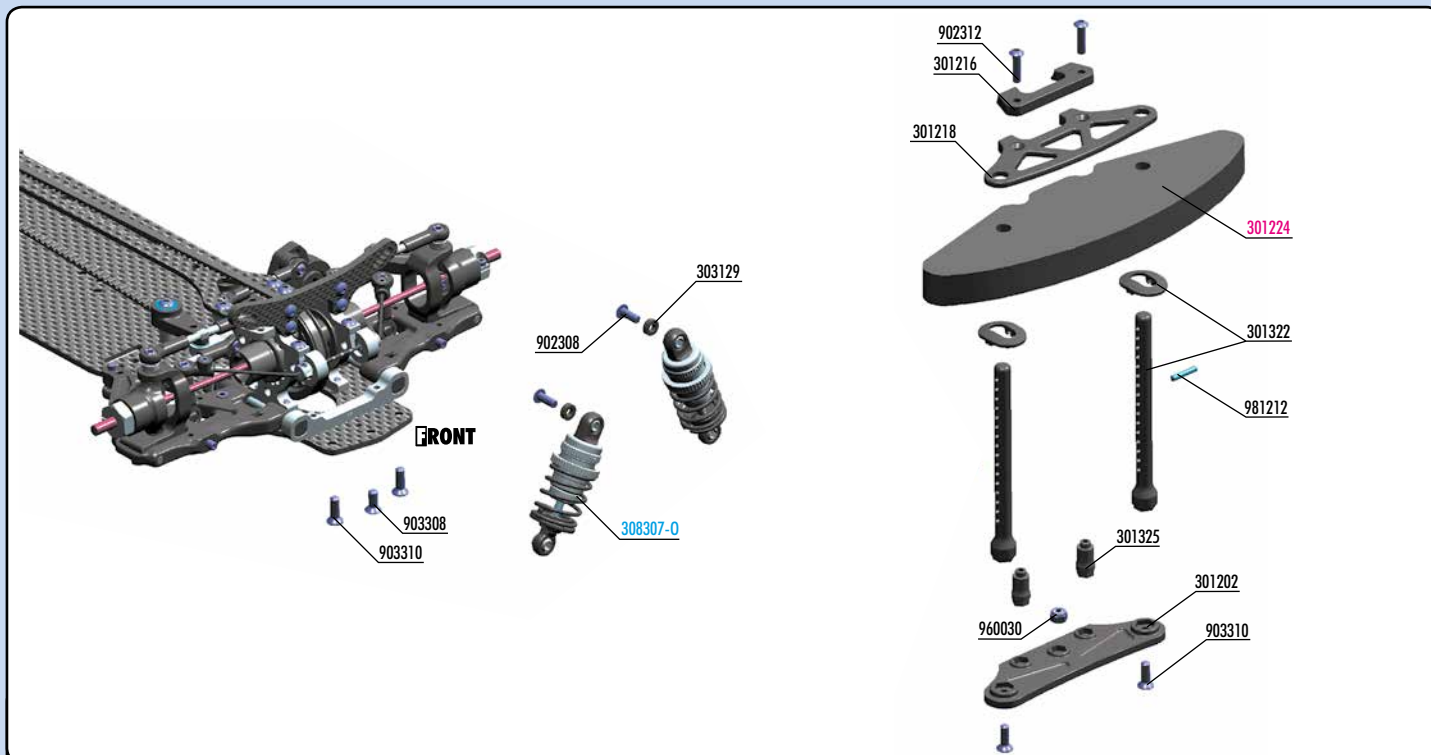

BAG

07

- 30 1202 COMPOSITE BUMPER
- 30 1213 GRAPHITE BUMPER UPPER HOLDER 2.5MM (OPTION)
- 30 1216 COMPOSITE BUMPER UPPER HOLDER BRACE
- 30 1218 COMPOSITE UPPER HOLDER FOR BUMPER
- 30 1322 FRONT BODY MOUNT SET
- 30 1323 FRONT BODY MOUNT SET + 1MM HEIGHT (OPTION)
- 30 1324 FRONT BODY MOUNT SET + 2MM HEIGHT (OPTION)
- 30 1325 T4 COMPOSITE BRACE FOR BUMPER - LOW (2)
- 30 3129 COMPOSITE SET OF WHEELBASE SHIMS (3x1MM; 1x2MM) (2)

- 90 2308 HEX SCREW SH M3x8 (10)
- 90 2312 HEX SCREW SH M3x12 (10)
- 90 3308 HEX SCREW SFH M3x8 (10)
- 90 3310 HEX SCREW SFH M3x10 (10)
- 96 0030 NUT M3 (10)
- 98 1212 PIN 2x12 (10)

30 1224 T4 FOAM BUMPER

30 8307-0 XRAY T4 ALU SHOCK ABSORBER-SET - ORANGE (2)



903308
SFH M3x8



903310
SFH M3x10



960030
N M3

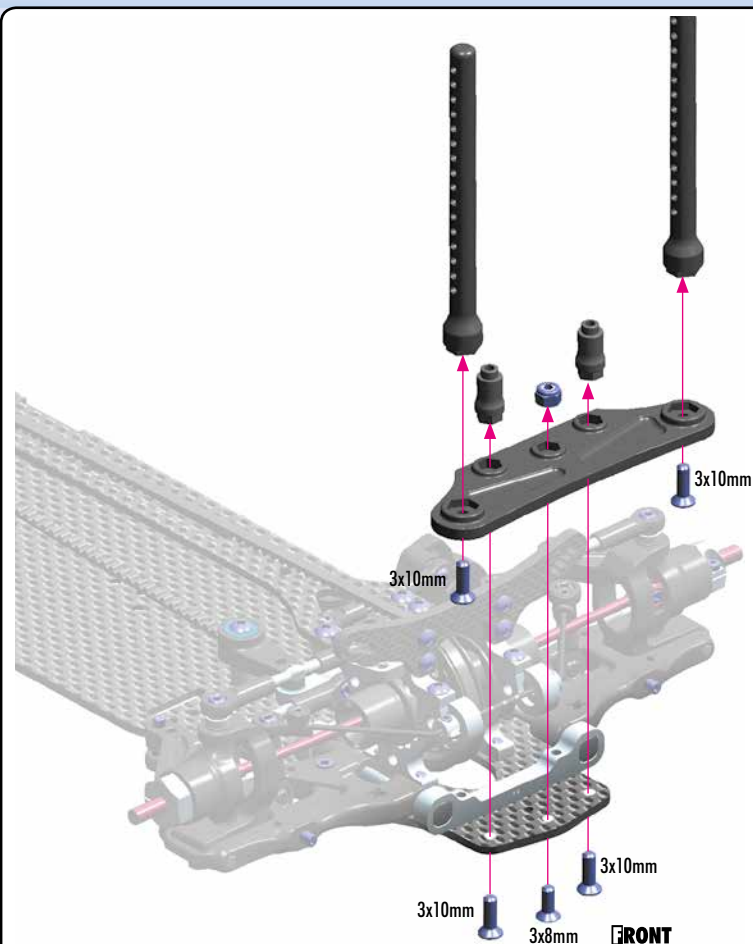

7. FRONT & REAR ASSEMBLY



902312
SH M3x12

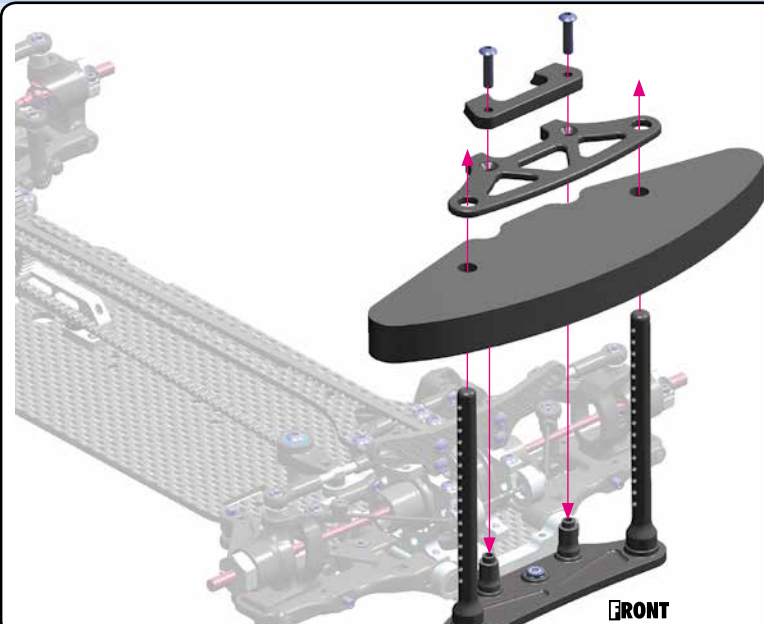

FRONT



981212
P 2x12

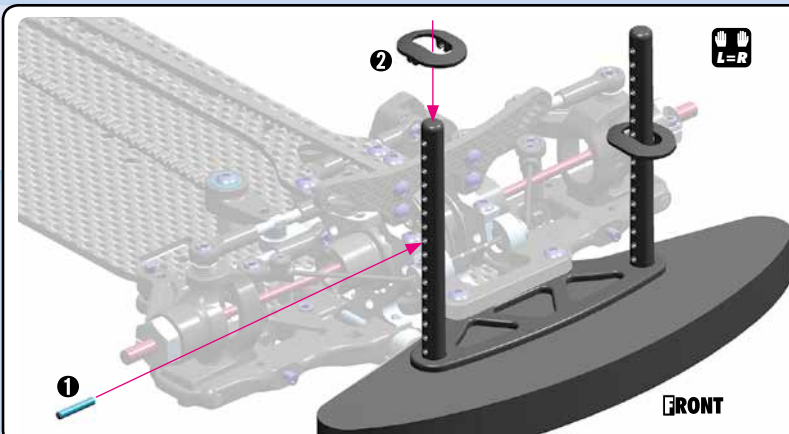

FRONT

OPTIONAL:

#301351-0

Alu Adjustable Body Post Stop (2)



Very handy, easily externally adjustable body post from Swiss 7075 T6 aluminum. Allows for adjustment of body height by 3mm without needing to change the position on the body post.



902308
SH M3x8

10

303129
SHIM 3x6x2

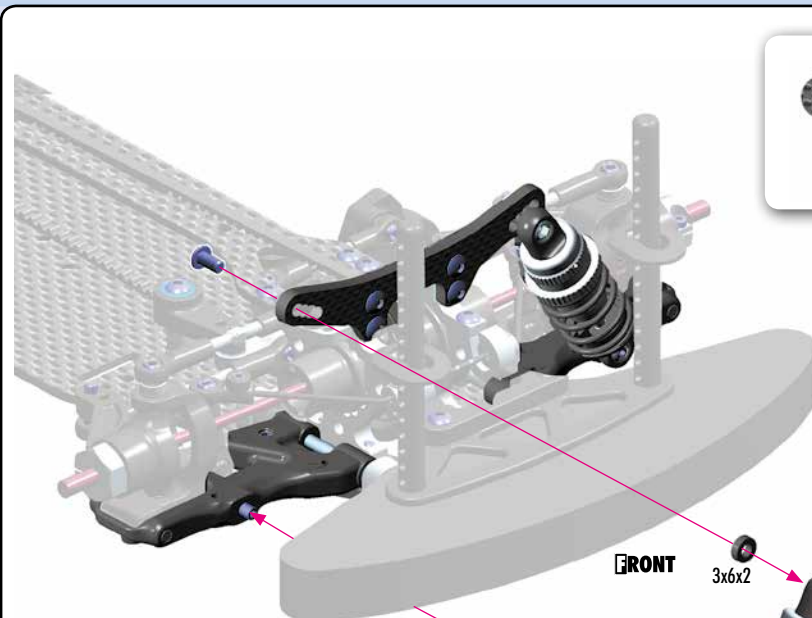

FRONT

3x6x2

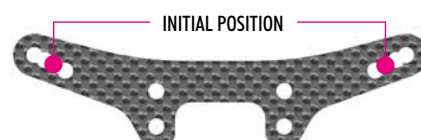

INITIAL POSITION



FRONT SHOCK
C2.5 SPRING



SHOCK POSITION
RIDE HEIGHT
DROOP

7. FRONT & REAR ASSEMBLY

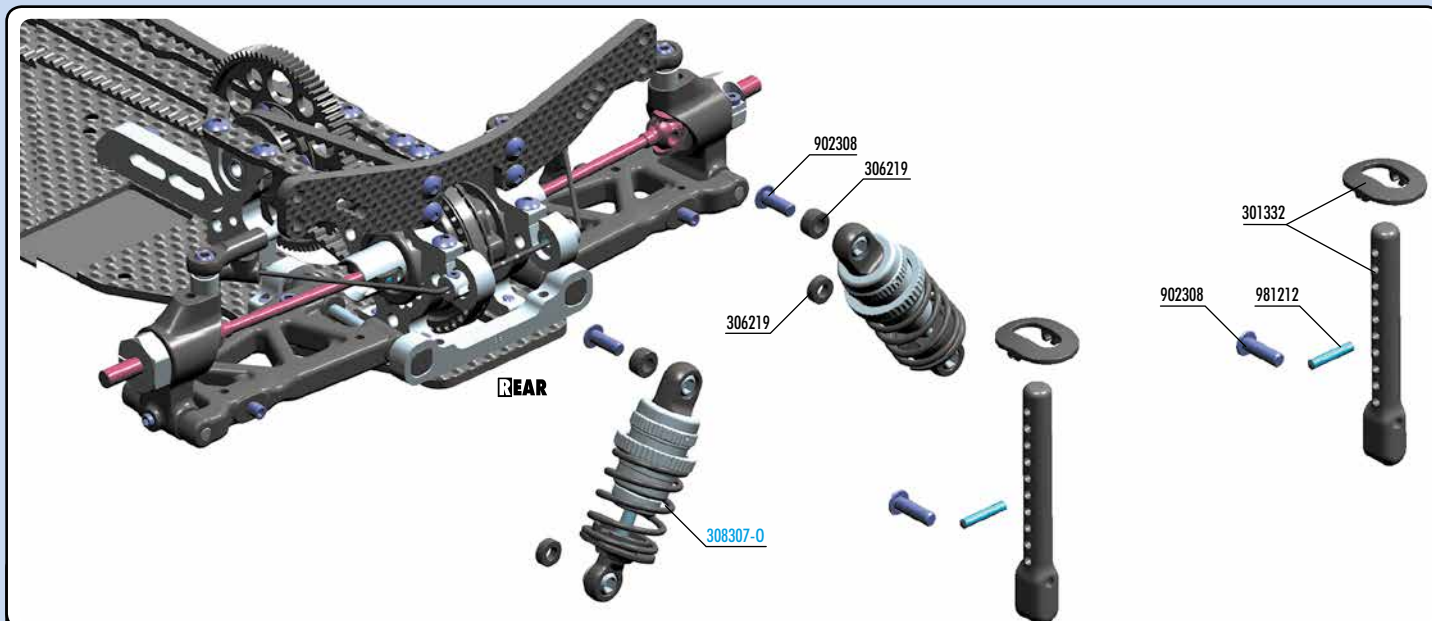

BAG
07

30 1332 REAR BODY MOUNT SET
30 1333 REAR BODY MOUNT SET +1MM HEIGHT (OPTION)
30 1334 REAR BODY MOUNT SET +2MM HEIGHT (OPTION)
30 6219 COMPOSITE SET OF SERVO SHIMS (4)

90 2308 HEX SCREW SH M3x8 (10)
98 1212 PIN 2x12 (10)

30 8307-0 XRAY T4 ALU SHOCK ABSORBER-SET - ORANGE (2)



902308
SH M3x8



981212
P 2x12

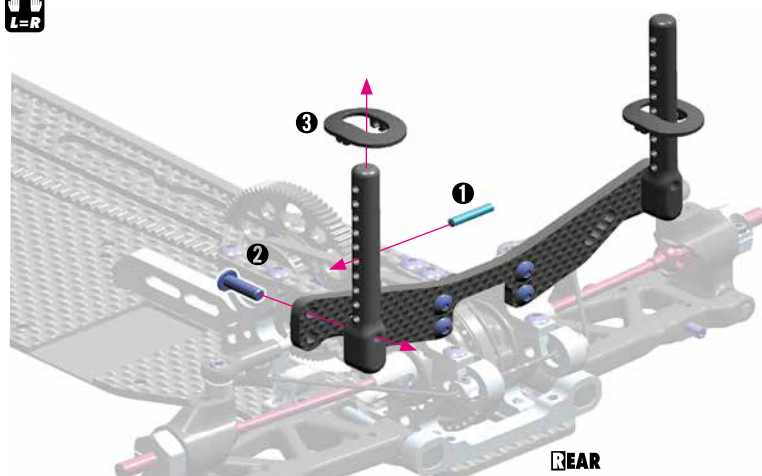

OPTIONAL:

#301351-0
Alu Adjustable Body Post Stop (2)



Very handy, easily externally adjustable body post from Swiss 7075 T6 aluminum. Allows for adjustment of body height by 3mm without needing to change the position on the body post.

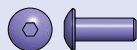

902308
SH M3x8

10

306219
SHIM 3x6x2

10

306219
SHIM 3x6x3

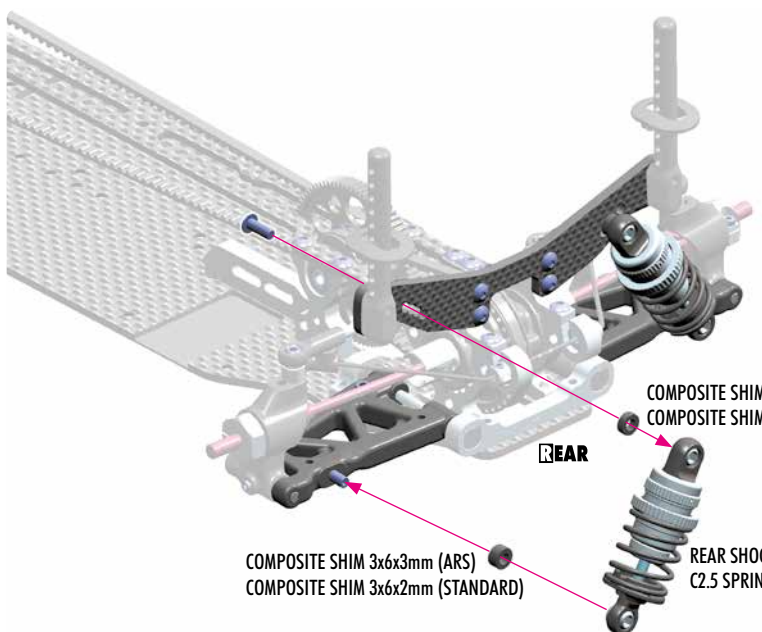

COMPOSITE SHIM 3x6x2mm (ARS)
COMPOSITE SHIM 3x6x3mm (STANDARD)

COMPOSITE SHIM 3x6x3mm (ARS)
COMPOSITE SHIM 3x6x2mm (STANDARD)

REAR SHOCK
C2.5 SPRING



**SET-UP
BOOK**

SHOCK POSITION
RIDE HEIGHT
DROOP

LIPO BATTERY PACK
(NOT INCLUDED)

SPEED CONTROLLER
(NOT INCLUDED)

RECEIVER
(NOT INCLUDED)

306310

306301

903308

902308

MOTOR
(NOT INCLUDED)

305912~306000
(NOT INCLUDED)

309402

903306

306231

306203-0

903306

306201

306219

STEERING SERVO
(NOT INCLUDED)

SERVO SCREW
(NOT INCLUDED)

902308

960140

306184

903305

309402

WHEELS & TIRES & INSERTS
(NOT INCLUDED)



- | | |
|---------|-----------------------------------|
| 30 6301 | ANTENNA MOUNT - THIN |
| 30 6231 | T4'15 GRAPHITE SERVO HOLDER 2.5MM |
| 30 9402 | BODY CLIP FOR 6MM BODY POST (4) |
| 90 2308 | HEX SCREW SFH M3x8 (10) |
| 90 3305 | HEX SCREW SFH M3x5 (10) |
| 90 3306 | HEX SCREW SFH M3x6 (10) |
| 90 3308 | HEX SCREW SFH M3x8 (10) |
| 96 0140 | NUT M4 WITH FLANGE (10) |

ANTENNA (2)

306219
SHIM 3x6x1

306219
SHIM 3x6x2

306219
SHIM 3x6x3

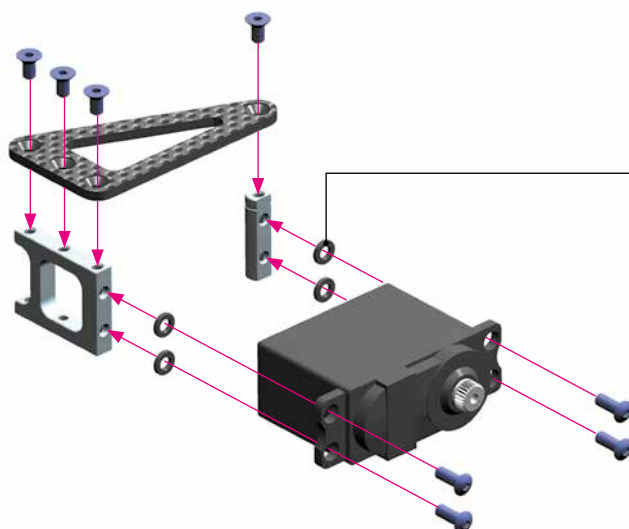

TOP
DETAIL

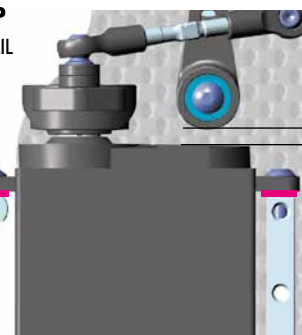

➤ Add shims between servo and alu servo mounts in case you want to move the servo (weight) more forward. There are 3 different thickness of shims.

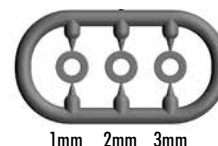

7. FINAL ASSEMBLY



903306
SFH M3x6

For improved weight balance and for more space for electronics, we recommend using a narrow, light servo.

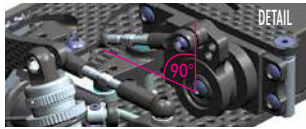

Attach servo arm to servo output shaft using screw from servo. Servo saver must be perpendicular to chassis when servo is in neutral.

! IMPORTANT!



When adjusting steering on the radio, we recommend using full steering adjustment in order to get the best steering from the car. It is important to verify that the steering block does not touch the C-hub; that would lead to chassis tweak due to extra servo strain.

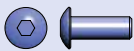
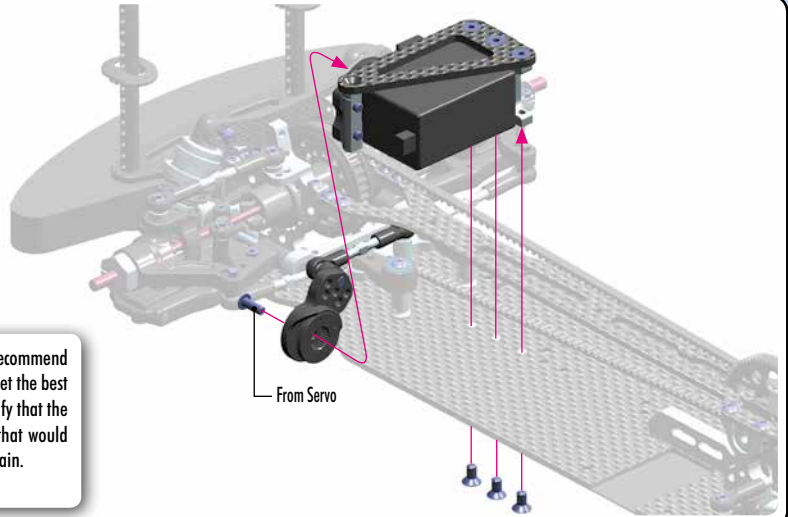

902308
SH M3x8

Adjust the motor so the pinion meshes with the spur gear properly. Make sure the gear mesh is not too tight.

There should be a small amount of play between the teeth of the pinion gear and the spur gear.



Recommended: 3x2.5mm set screw (#901302) (NOT INCLUDED)



Some motors do not have a chamfer on the motor housing. If your motor does not have a chamfer on the housing and you want to use a small pinion, the motor may touch the top deck. Use a moto-tool with grinding bit or file to remove material from the top-deck; this will allow the motor to be moved closer to the spur gear.

TIP For tightening and loosening the pinion set screw, use the indicated chassis hole.

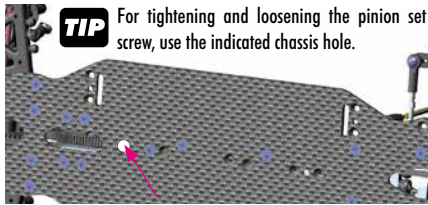

OPTIONAL:
#303061 LiPo Chassis
Graphite Motor Guard

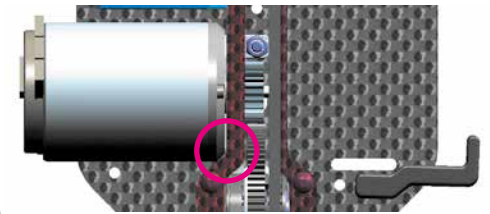

GEARING ADJUSTMENT



903308
SFH M3x8

Feed the receiver wire into the antenna tube

RECEIVER (NOT INCLUDED)



NOTE: In case the antenna tube does not hold the antenna properly, apply a small drop of the CA glue to the outside end of the antenna tube while inserting it into the holder. Make sure not to apply glue to the inside of the antenna tube, or the antenna wire may get permanently stuck.

SPEED CONTROLLER (NOT INCLUDED)

DOUBLE-SIDED TAPE (NOT INCLUDED)

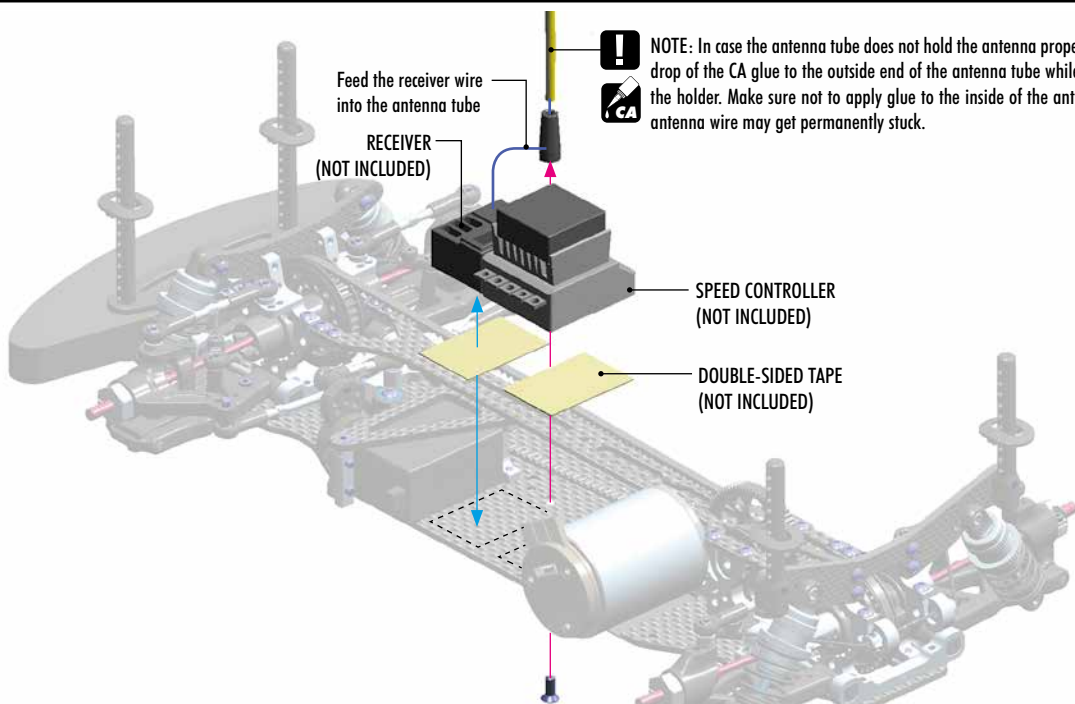

7. FINAL ASSEMBLY



903305
SFH M3x5



903306
SFH M3x6

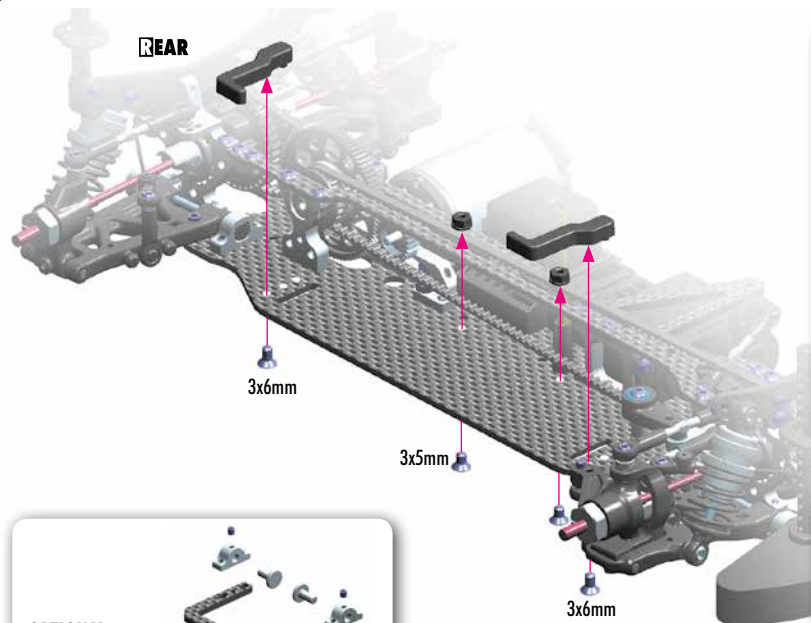

OPTIONAL:
#306191
T4 Graphite + Alu Fully
Adjustable Battery Holder

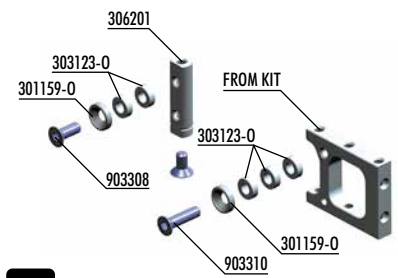

TIP

Using the optional stand and shims with screw, there is a possibility to adjust side battery position which has direct influence on the side balance of the car.

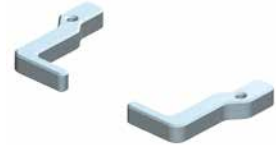

OPTIONAL:
#306186 Alu LiPo Battery Backstops (F + R)

4x

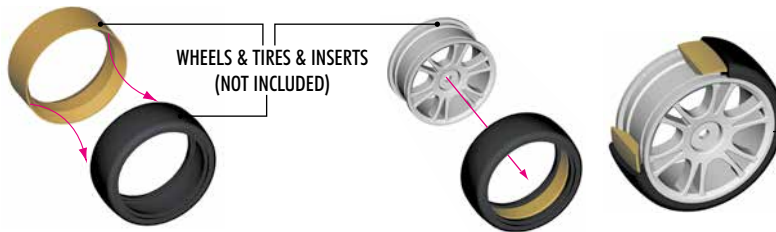

WARNING!

Follow the adhesive manufacturer's instructions for proper use and safety. Wear proper eye and hand protection.



960140
N M4

Make sure the wheel nuts are very tight, so the wheels do not loosen during racing.

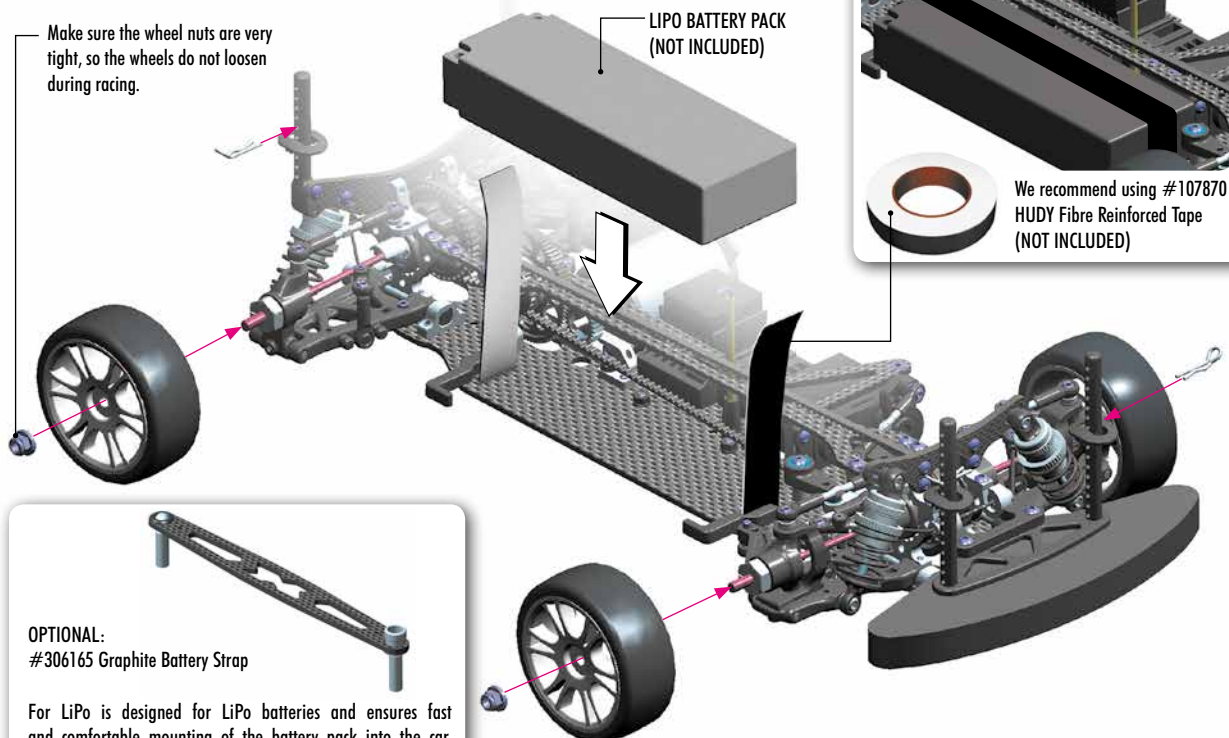

OPTIONAL:
#306165 Graphite Battery Strap



For LiPo is designed for LiPo batteries and ensures fast and comfortable mounting of the battery pack into the car. Depending on the height of LiPo batteries additional shims may have to be mounted below the stands.

www.teamxray.com

XRAY EUROPE

XRAY, K VÝSTAVISKU 6992, 91101 TRENCIN, SLOVAKIA, EUROPE
PHONE: +421-32-740 11 00, FAX: +421-32-740 11 09, info@teamxray.com

XRAY USA

RC AMERICA, 2030 Century Center Blvd #15, Irving, TX 75062, USA
PHONE: 214-744-2400, FAX: 214-744-2401, xray@rcamerica.com